



Uniexpress 18

Fast Crewboat/ Utility Vessel

PRINCIPAL PARTICULARS

| | |
|-----------------|--|
| Year Built | 2009 |
| Place Built | Thailand |
| Design | 40M Crew / Utility Vessel, Marsun Co. Ltd. |
| Flag | Thailand |
| Length Overall | 40.00 m |
| Length BP | 37.50 m |
| Breadth Moulded | 7.60 m |
| Depth Moulded | 3.60 m |
| Draft (max) | 1.70 m |
| Freeboard (SLL) | 1.21 m |
| Class | BV |
| Notation | I, + HULL, + MACH, Crewboat, Cargo Utility Vessel, Unrestricted Navigation |
| GRT/ NRT | 247.00 T / 74.00 T |
| Deadweight | 120.00 T |

DECK PARTICULARS

| | |
|--------------------|-----------------------|
| Clear Deck Area | 120.00 m ² |
| Deck Carrying Load | 50.00 T |
| Deck Strength | 2.00 T/m ² |

PERFORMANCE

| | |
|----------------|------------------------------------|
| Maximum Speed | 24 Knots @ 15 T/24 hrs @ 32 DWT |
| Economic Speed | 18 Knots @ 9.2 T / 24 hrs @ 32 DWT |

PROPULSION SYSTEM

| | |
|----------------------|--|
| Main Engines | 3 Units x Cummins KTA38-M2, 1350 BHP, 1007 kW @ 1950 RPM, Total BHP = 4050 |
| Auxiliary Engines | 2 x Cummins 6BT5.9, 80 kW @ 1500 RPM |
| Propellers | 3 x Nickel-Aluminium Bronze 4-Blade Propellers Stone Marine |
| Steering Gear System | 2 x RIQ, 7087U12-2.5-35-T |
| Rudder | 2 Units |

TANK CAPACITIES

| | |
|-------------|----------------------|
| Fuel Oil | 50.00 m ³ |
| Fresh Water | 20.00 m ³ |

CARGO DISCHARGE CAPACITIES

| | |
|------------------|---|
| Fuel Oil Pump | 20.00 m ³ /hr, 2900 RPM, Azcue BT-IL52D3 |
| Fresh Water Pump | 20.00 m ³ /hr, Max Ht= 40 m, Azcue CA50/7A |
| Bilge | 30 m ³ /h, 2900 RPM, Azcue CA-50-7 Ø185 |

DECK EQUIPMENT

| | |
|-------------------------|--|
| Anchor Windlass c/w Bow | MARSUN, 120 kg Anchor, 1.25 m Chain, 100 m Wire Rope |
|-------------------------|--|

ACCOMMODATION

| | |
|-----------------|-------------------|
| Passenger Seats | 70 |
| Crew | 2 x 4, 2 x 1 = 10 |



EXTERNAL FIRE-FIGHTING EQUIPMENT

| | |
|-----------------------|---|
| Fi-Fi Notation | ACP, 600 m ³ /h, 250DF |
| Fi-Fi Monitors | 600 m ³ /hrs, 100 m Throw Length |
| Fi-Fi Pump | 600 m ³ /hr |
| Oil Dispersant System | Nil |

INTERNAL FIRE-FIGHTING & ANTI-POLLUTION EQUIPMENT

| | |
|------------------------|--|
| Emergency Fire Pump | Azcue CA 50-7 Ø 185, 30 m ³ /hr, 2900 RPM |
| CO2 Fi-Fi System | 4 x Fixed CO2 System for Engine Room |
| Fire Detection & Alarm | Notifier, NFS2-640/E |

LIFE-SAVING EQUIPMENT

| | |
|------------|-----------------------------|
| Life Rafts | 8 x 20 men, SOLAS Compliant |
|------------|-----------------------------|

Particulars are believed to be correct but not guaranteed. Owners reserve the rights to amend the specifications without notifications. Particulars are entirely without warranty as to correctness and interested parties must inspect vessel's certificates, drawings or physical inspection of vessel.

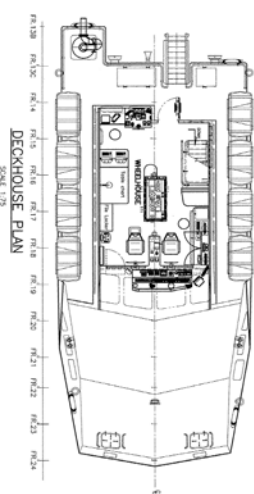

MAIN CHARACTERISTICS

| | | |
|---------------------------------|-------|------------|
| LENGTH OVER ALL | 40.00 | M. |
| LENGTH WATERLINE (Draft Loaded) | 37.50 | M. |
| BREADTH MOULDED | 7.60 | M. |
| DEPTH MOULDED | 3.60 | M. |
| DRAFT (DESIGN) | 1.25 | M. |
| DRAFT (LOADED) MLD.(APPROX) | 1.70 | M. |
| COMPLEMENT | 10 | CREW |
| FUEL OIL | 71 | PASSENGERS |
| PORTABLE WATER | 50 | CUM |
| CLEAR DECK SPACE | 20 | Sq.M |
| | 120 | Sq.M |

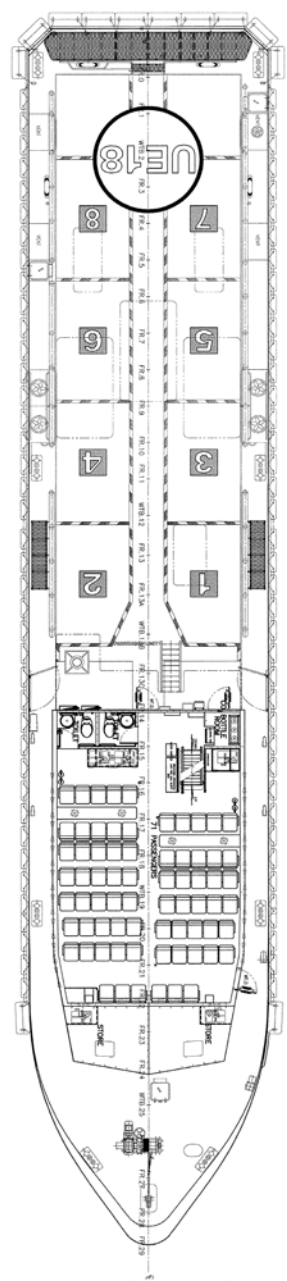
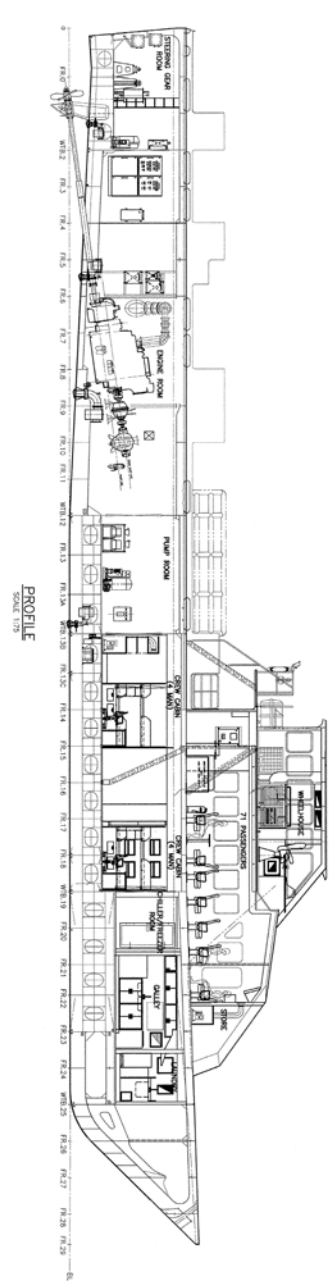

| | | | | |
|--|------|-------------|--------|------------------------|
| AS-BUILT | | NO. 1 SHEET | REV. 1 | DATE |
| COPIES | NO. | DATE | BY | REASON |
| 1 | 1 | 11/17/2014 | MEG | ISSUE FOR CONSTRUCTION |
| <p>MARSSUN COMPANY LIMITED 40th CREW UTILITY VESSEL PROJECT NO. 232</p> | | | | |
| <p>GENERAL ARRANGEMENT (INBOARD)</p> | | | | |
| <p>DESIGNED BY: MEG DRAWN BY: S. KIM CHECKED BY: MEG APPROVED BY: MEG DATE: 11/17/14 PROJECT NO.: 232</p> | | | | |
| <p>THIS DRAWING RELATES TO VESSEL NO. 232 (L801) 02 CENTERLINE OF VESSEL FROM AFT PERMANENT MARKING GENERAL NO. 232 (L801) 02</p> | | | | |
| SCALE | 1:25 | SHEET | 1 | OF |
| <p>FILE NAME: S:\232-1-801-02\232 GANBOY\01.DWG</p> | | | | |

