



EXPRESS 90

Fast Utility Craft/ Crewboat

PRINCIPAL PARTICULARS

Year Built	2015
Place Built	Batam, Indonesia
Design	Penguin Shipyard Int'l
Flag	Panama
Length Overall	40.00 m
Length BP	36.51 m
Breadth Moulded	7.60 m
Depth Moulded	3.65 m
Draft (max)	1.90 m
Freeboard (SLL)	1.40 m
Class	BV
Notation	I + Hull + MACH, Crewboat, Sea area 3 (Max. Significant Wave Height > 3.00 m)
GRT/ NRT	272.00 T / 81.00 T
Deadweight	128.23 T

DECK PARTICULARS

Clear Deck Area	100.00 m ²
Deck Carrying Load	60.00 T
Deck Strength	2.00 T/m ²

PERFORMANCE

Maximum Speed	28 Knots @ 35 DWT
Economic Speed	25 Knots @ 35 DWT

PROPULSION SYSTEM

Main Engines	2 x 1350 BHP & 1 x 1800 BHP, Cummins KTA38M2 & KTA50M2 (IMO Tier II) @ 1900 RPM
Auxiliary Engines	3 x Cummins, 6CT8.3D(M), 90 kW @ 1500 RPM
Portable Generator	Denko KDE3300
Emergency Generator	Nil
Bow Thruster	Hoyer, Y2E.280MB-4, 1.4 T Thrust
Propellers	3 x Fixed Pitch Propellers, 5-blade
Steering Gear System	2 x RIQ Steering Gear, PURQ8006D02204
Rudder	2 x Mencast

TANK CAPACITIES

Fuel Oil	73.70 m ³
Fresh Water	29.40 m ³

CARGO DISCHARGE CAPACITIES

Fuel Oil Pump	23.00 m ³ /hr
Fresh Water Pump	Nil
Bilge	30.00 m ³ /hr

DECK EQUIPMENT

Anchor Windlass c/w Bow	TYPE HHAW1532A, Chain Cable Diameter 17 mm, Primer Mover Type Hydraulic
Crane	Nil



ACCOMMODATION

Passenger Seats	100
Crew	2 x 1, 4 x 2 = 10

EXTERNAL FIRE-FIGHTING EQUIPMENT

Fi-Fi Notation	Equivalent to 1/4 FiFi c/w Water Spray System
Fi-Fi Monitors	600 m ³ /hr @ 100 m Throw Length
Fi-Fi Pump	600 m ³ /hr @ 130m Head
Oil Dispersant System	1 V-Jet Nozzles (P&S), 200 L

INTERNAL FIRE-FIGHTING & ANTI-POLLUTION EQUIPMENT

Emergency Fire Pump	Matsuka/Yanmar, 30m ³ /hr @ 35 m Head
CO2 Fi-Fi System	Fixed CO2 System for Engine Room
Fire Detection & Alarm	Optical, Multi-Sensor Smoke & Heat Detector Alarm

LIFE-SAVING EQUIPMENT

Life Rafts	8 x 25, 2 x 10 men, SOLAS Compliant
Rescue Boat c/w Davit	Nil

LENGTH O.A.: 40.00 M
 LENGTH B.P.: 36.51 M
 LENGTH W.L.: 37.46 M
 BREADTH MLD.: 7.60 M
 DEPTH MLD.: 3.65 M
 DESIGN DRAFT: 1.90 M
 MAX. WAVE HEIGHT: 3 M
 COMPLEMENT: 10 CREW MEMBERS
 100 OFFSHORE WORKERS
 Class Notation: BV1 + HULL + MACH CREW BOAT
 CARGO UTILITY VESSEL, SEA AREA 3

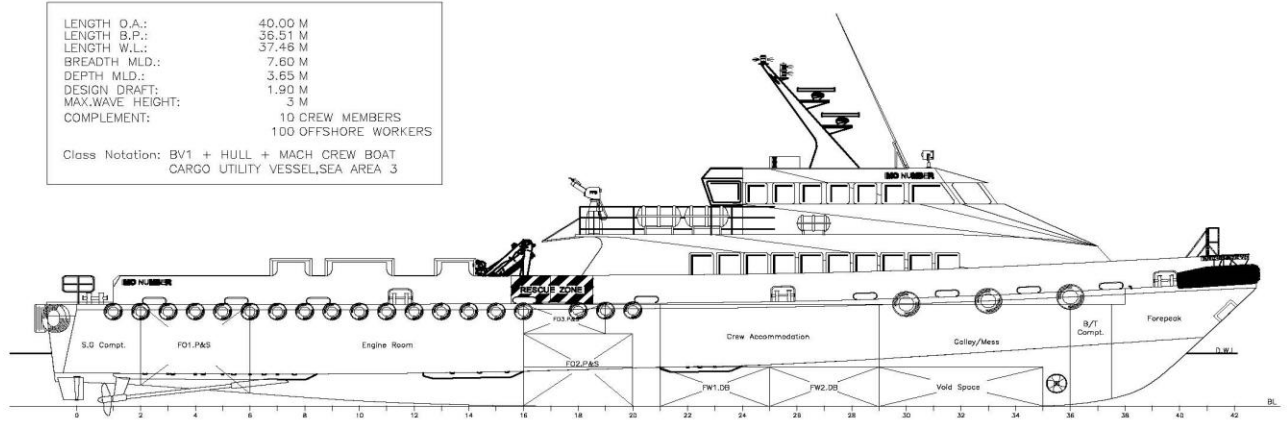

PROFILE

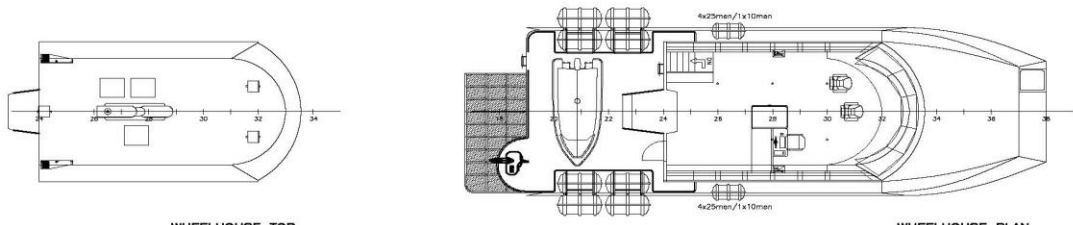

WHEELHOUSE TOP

WHEELHOUSE PLAN

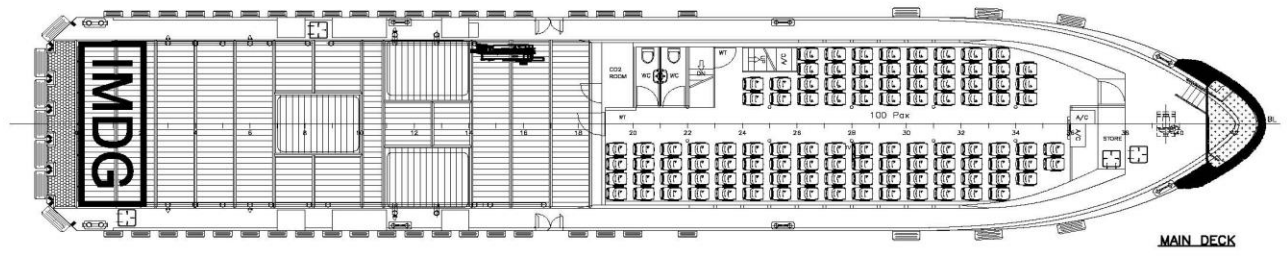

MAIN DECK

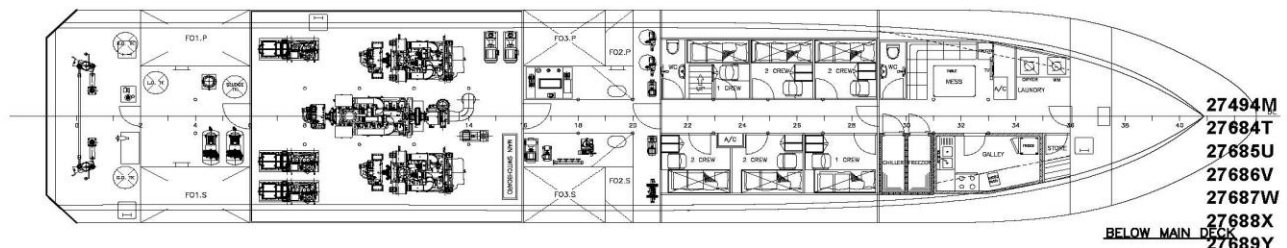

BELOW MAIN DECK

- 27494M
- 27684T
- 27685U
- 27686V
- 27687W
- 27688X
- 27689Y

BUREAU VERITAS Section 27695F.....
VU avec observations
 Singapore, 03-Aug-2014

[Electronic document]
 The plan approval office
 SPO/14/02904

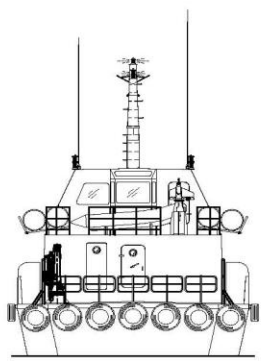

STERN VIEW

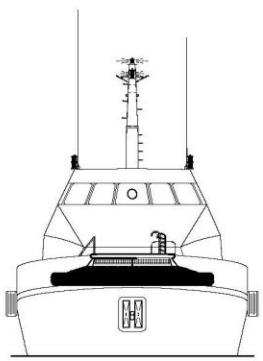

FRONT VIEW

PROJECT:	FLEX-40S (H255,260,261,263,264,265,268,276)		
TITLE:	GENERAL ARRANGEMENT		
PENGUIN SHIPYARD INTERNATIONAL PTE LTD 18 Tuas Basin Link, Singapore 638784 Tel: 68628322 Fax: 68622150			
This drawing and the information contained herein is supplied on the understanding that they are the exclusive property of Penguin Shipyard International Pte Ltd. They must not be used or reproduced in whole or in part, without permission in writing.			
DRAWN:	STEPHEN	DATE:	27.MAR.2014
CHECKED:	YAW JH	DATE:	28.MAR.2014
APPROVED:	CHEW KH	DATE:	28.MAR.2014
DRAWING No.:	PSI-H255-C-01	SHEET:	1 OF 1