



EXPRESS 77

Fast Utility Craft/ Crewboat

PRINCIPAL PARTICULARS

Year Built	2013
Place Built	Indonesia, Batam
Design	Penguin Shipyard Int'l
Flag	Panama
Length Overall	38.00 m
Length BP	36.94 m
Breadth Moulded	7.60 m
Depth Moulded	3.65 m
Draft (max)	1.89 m
Freeboard (SLL)	1.41 m
Class	BV
Notation	I, Hull, Mach, Crewboat, Unrestricted Navigation, Max Significant Wave Ht < 3.0 m
GRT/ NRT	257.00 T / 77.00 T
Deadweight	123.00 T

DECK PARTICULARS

Clear Deck Area	80.00 m ²
Deck Carrying Load	55.00 T
Deck Strength	2.00 T/m ²

PERFORMANCE

Maximum Speed	27 Knots @ 35 DWT
Economic Speed	25 Knots @ 35 DWT

PROPULSION SYSTEM

Main Engines	3 x Cummins KTA 38-M2, 1350 BHP, Total 4050 BHP
Auxiliary Engines	3 x Cummins 6BT5.9-DM1, 80 kW @ 415/220/3Phase/50Hz
Portable Generator	Denko KDE 3300
Emergency Generator	Nil
Bow Thruster	75 HMM-650, 0.9 T Thrust
Propellers	3 x Fixed Pitch Propellers, 5-blade
Steering Gear System	2 x Duplex Electro Hydraulic Pump system
Rudder	2 Units

TANK CAPACITIES

Fuel Oil	68.77 m ³
Fresh Water	30.92 m ³

CARGO DISCHARGE CAPACITIES

Fuel Oil Pump	23 m ³ /hr, TECO 7.5 HP 5.5kW
Fresh Water Pump	Marathon 5 KC39RN114GT 3/4hp
Bilge	Nil

DECK EQUIPMENT

Anchor Windlass c/w Bow	Hypac Electro Hydraulic Winch c/w Wire Rope, Chain & Single Anchor
-------------------------	--



ACCOMMODATION

Passenger Seats	90
Crew	1 x 1, 1 x 3, 3 x 2 = 10

EXTERNAL FIRE-FIGHTING EQUIPMENT

Fi-Fi Notation	Equivalent to 1/4 Fi-Fi c/w Water Spray System
Fi-Fi Monitors	600 m ³ /h, 100 m Throw Length
Fi-Fi Pump	600 m ³ /hr @ 100m, 250x350xP
Oil Dispersant System	Inductor, Proportional Pump, 200 L

INTERNAL FIRE-FIGHTING & ANTI-POLLUTION EQUIPMENT

Emergency Fire Pump	30m ³ /hr @ 35 m head
CO2 Fi-Fi System	Fixed CO2 System for Engine Room
Fire Detection & Alarm	Optical Smoke, Multi-Sensor Smoke & Heat Detector

LIFE-SAVING EQUIPMENT

Life Rafts	4 x 10, 8 x 25 men
Rescue Boat c/w Davit	1 x 6 men, 25 HP, 20 L Fuel Capacity, SOLAS Compliant

MAIN PARTICULARS:

LENGTH O.A.: 38.00 M
 LENGTH B.P.: 34.71 M
 BREADTH MLD.: 7.60 M
 DEPTH MLD.: 3.65 M
 DESIGN DRAFT: 1.890 M
 COMPLEMENT: 10 CREW MEMBERS
 90 OFFSHORE WORKERS

Class Notation: BV, I +HULL +MACH, CREWBOAT
 UNRESTRICTED NAVIGATION, Max. WAVE
 HEIGHT NOT EXCEEDING 3.0M

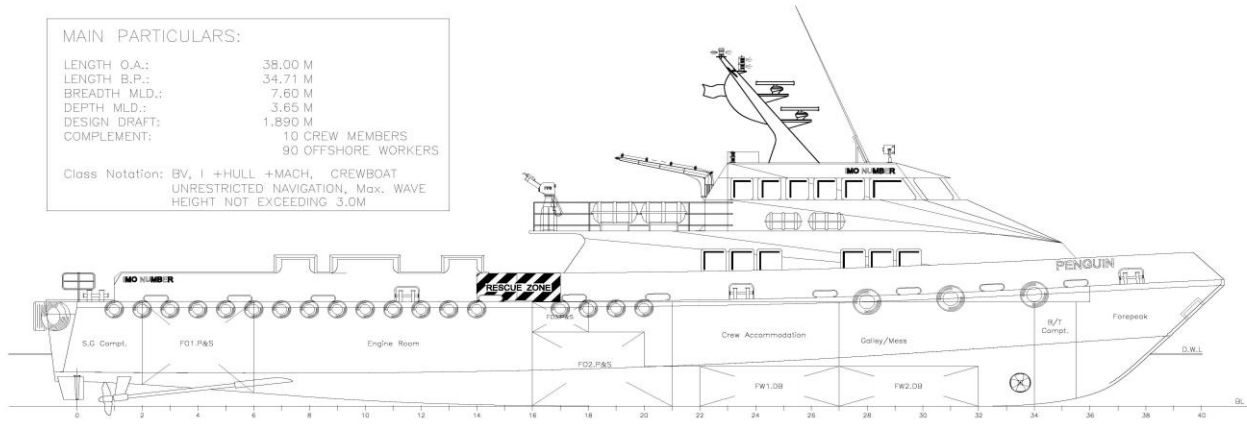

PROFILE

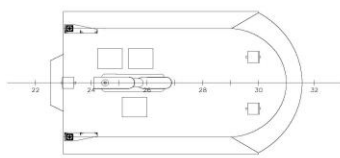

WHEELHOUSE TOP

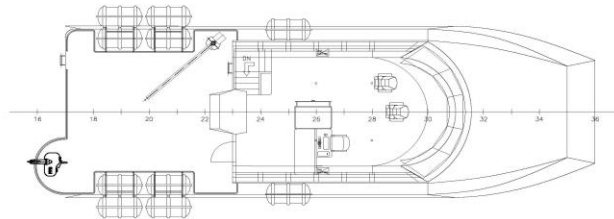

WHEELHOUSE PLAN

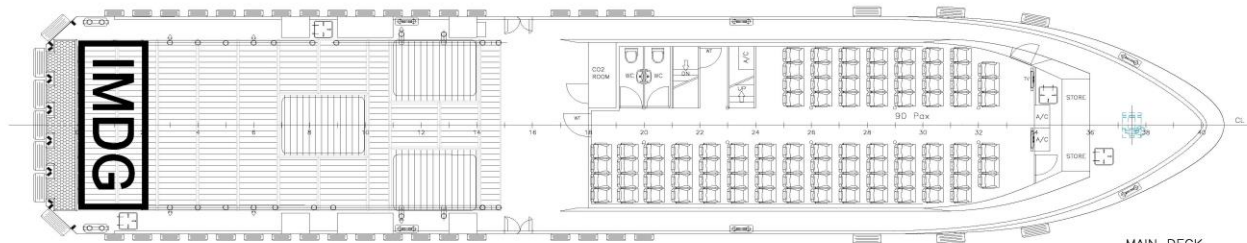

MAIN DECK

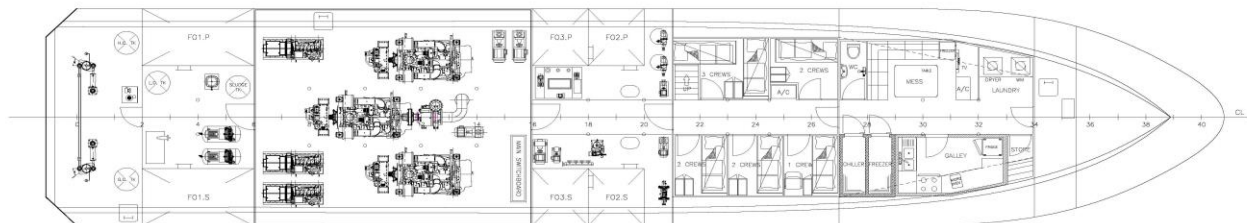

BELOW MAIN DECK

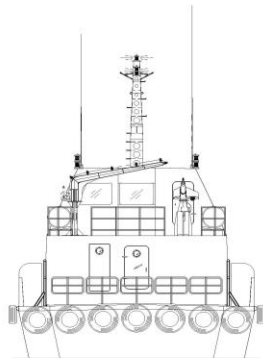

STERN VIEW

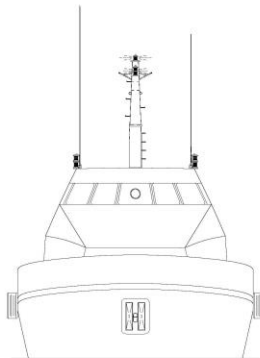

FRONT VIEW

ASBUILT DRAWING - OWNERS REQUEST		D	UP	DCF	4-NOV-15
DESCRIPTION	REV	DRN BY	CHK BY	DATE	
CLIENT:					
MICLYN EXPRESS OFFSHORE					
		TITLE: GENERAL ARRANGEMENT PLAN			
		SHIP NAME: Express 77			
DRAWING NO.: MEC-EXP77-GAP-001		SCALE: 1:80			
DRAWN: IJR		REV. NO.: C		SHEET NO.: 1 OF 1	
CHECKED: DCF		SHEET NO.: 1 OF 1		SIZE: A1	
APPROVED: ERIK TING		DATE: 29 SEPTEMBER 2015			
<small>Head Office (Singapore): No. 2 Harbour Front Place, #11-01/04 Harbour Front Tower 2 Singapore 099594 Tel: (65) 65462111 Fax: (65) 62754372 www.miclynexpressoffshore.com This document contains Confidential Proprietary information and shall not be Copied, Reproduced, Used, Transferred to other Documents or Disclosed to others for any purpose unless Authorized by MEO.</small>					