



MEO
MICLYN EXPRESS OFFSHORE

EXPRESS 3

Fast Utility/ Crewboat

PRINCIPAL PARTICULARS

Year Built	2004
Place Built	Australia
Design	-
Flag	Panama
Length Overall	20.83 m
Length BP	-
Breadth Moulded	4.80 m
Depth Moulded	1.35 m
Draft (max)	1.00 m
Freeboard (SLL)	-
Class	BV
Notation	I + Hull + Mach, Crew Boat, Unrestricted Navigation
GRT/ NRT	31.00 T/ 10.00 T
Deadweight	15.00 T

DECK PARTICULARS

Clear Deck Area	23.70 m ²
Deck Carrying Load	8.00 T
Deck Strength	1 T/m ²

PERFORMANCE

Maximum Speed	23 Knots @ 4.7 MT/24 hrs
Economic Speed	17 Knots @ 3.5 MT/24 hrs

PROPULSION SYSTEM

Main Engines	2 x CAT C12, 570 BHP, 425 kW @ 2300 RPM, 1140 BHP
Auxiliary Engines	2 x Yanmar 4 TNE94, 29.1KW @ 1500 RPM
Propellers	2 Units
Steering Gear System	2 X Hydraulic
Rudder	2 x Semi balanced

TANK CAPACITIES

Fuel Oil	9.00 m ³
Fresh Water	2.00 m ³

ACCOMMODATION

Passenger Seats	12
Crew	12



INTERNAL FIRE-FIGHTING & ANTI-POLLUTION EQUIPMENT

Emergency Fire Pump	KIPOR KDP 20 DIESEL, KM 170F, Rotation Speed: 2.5/3000 KW/min
CO2 Fi-Fi System	1 x 25kg CO2 Cylinder
Fire Detection & Alarm	ITIM System, FA4

LIFE-SAVING EQUIPMENT

Life Rafts	2 x 20 men
Rescue Boat c/w Davit	Nil

PRINCIPAL DIMENSIONS

LOA: 20.83 m
 DWL: 18.77 m
 BREADTH: 4.8 m
 DRAUGHT: 1.07 m

OUTBOARD PROFILE

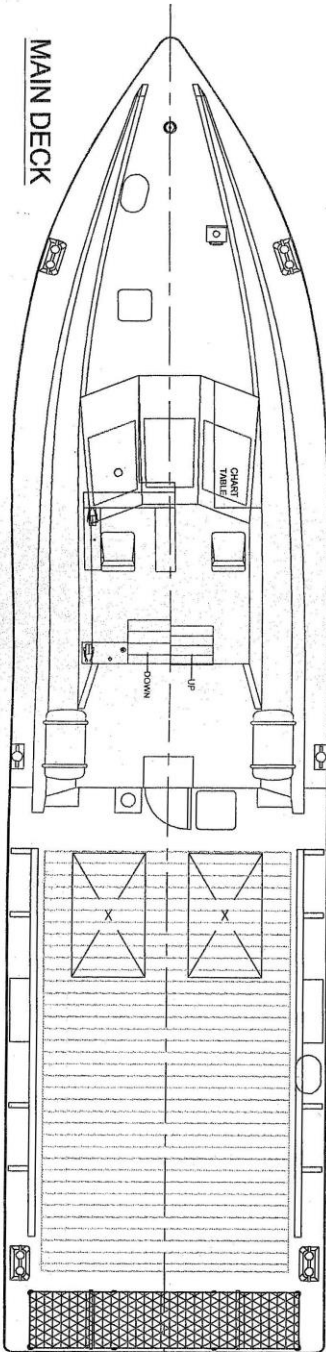
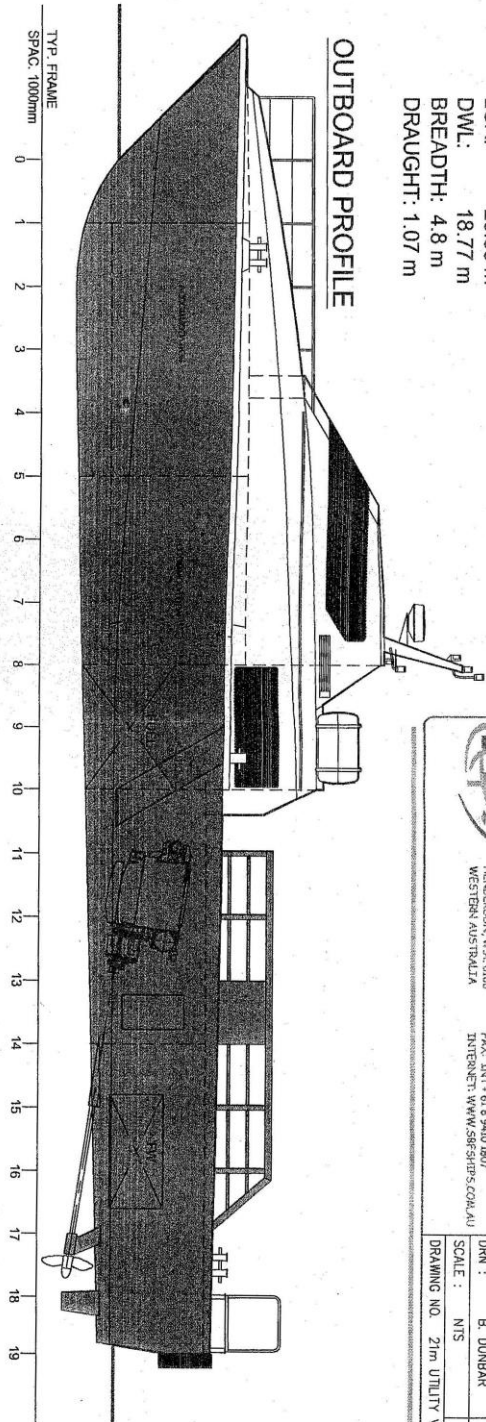

MAIN DECK

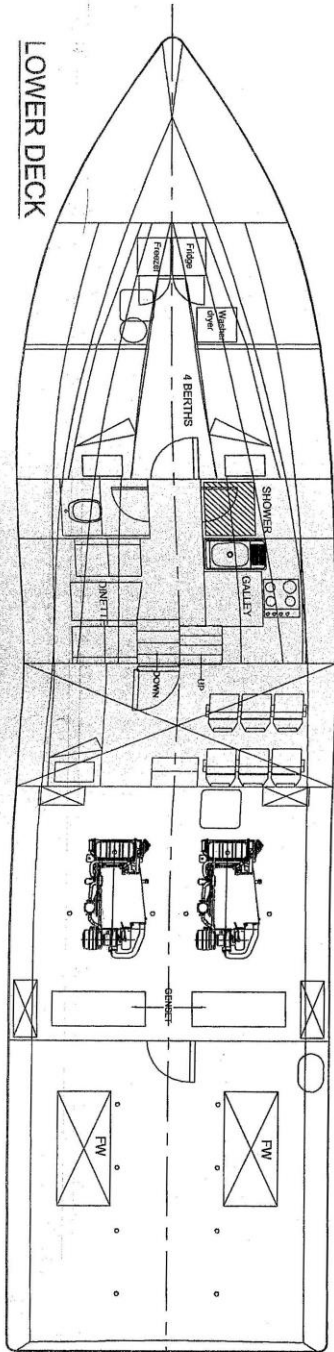

LOWER DECK

ENP



S B F SHIPBUILDERS MOB: 009 325 1179
 LOT 211 GARDNER BEACH RD
 HENDERSON VIC 3175
 WESTERN AUSTRALIA
 PHONE: INT +61 8 9410 2244
 FAX: INT +61 8 9410 2807
 INTERNET: WWW.SBF.SHIPBUILDERS.COM.AU

VESSEL :	GENERAL ARRANGEMENT
TITLE :	21MUP241
DRN :	B. DUNBAR
DATE :	20/01/04
SCALE :	NIS
DRAWING NO :	21m UTILITY VESSEL
REV :	0

