



MEO GALAXY

70M / 3500BHP / Maintenance/Support Vessel

PRINCIPAL PARTICULARS

Year Built	2011
Place Built	Guanzhou Panyu Lingshan Shipyard, China
Design	0
Flag	Malaysia
Length Overall	70.16 m
Length BP	65.72 m
Breadth Moulded	19.52 m
Depth Moulded	4.88 m
Draft (max)	3.00 m
Freeboard (SLL)	0.60 m
Class	BV
Notation	1 x Hull x Mach, Supply Vessel, Unrestricted Navigation
GRT/ NRT	2554.00 T / 766.00 T
Deadweight	1500.00 T
Bollard Pull	Nil

DECK PARTICULARS

Clear Deck Area	500.00 m ²
Deck Carrying Load	600.00 T
Deck Strength	7.00 T/m ²

PERFORMANCE

Maximum Speed	10 Knots @ 12 MT/24 hrs
Economic Speed	7 Knots @ 9 MT/24 hrs

PROPULSION SYSTEM

Main Engines	2 x Caterpillar 3512B, 1750 BHP @ 1600 RPM, Total 3500 BHP
Auxiliary Engines	3 x Caterpillar C18, 450 kW @ 1500 RPM
Emergency Generator	1 x Cummins, 136 kW @ 1500 RPM
Bow Thruster	Caterpillar C18, 8 T Thrust
Stern Thruster	Nil
Propellers	2 x Fixed Pitch Propellers in Kort Nozzles
Steering Gear System	2 x Hydraulic Steering Gear
Rudder	2 x High Performance Streamline Type

TANK CAPACITIES

Fuel Oil	558.00 m ³
Fresh Water	564.00 m ³
Bilge	5.16 m ³
Ballast Water	1246

CARGO DISCHARGE CAPACITIES

Fuel Oil Pump	100 m ³ /hr @ 75 m head
Fresh Water Pump	100 m ³ /hr @ 75 m head
Bilge Pump	60 m ³ /hr @ 50 m head



DECK EQUIPMENT

Anchors & Chain	2 x HHP 1730 kg /w 17 Shackles
Tugger Winch	2 x Electro-Hydraulic, 10 T @ 15 m/min
Capstan	2 x Electro-Hydraulic 10 T @ 15 m/min
Anchor Windlass c/w Bow	2 x 10 Hydraulic Motor
Mooring Anchor	4 x 4 T Delta Flipper Type + 1 spare
Mooring Winches	4 x SWL 40 T Hydraulic Motor
Brake Holding	80 T
Spooling Capacity	30T @ 10m/mnt
Buoys	Nil
Crane	SWL 12 mt@ 37 meter radius
Fairhead	Nil

ACCOMMODATION

Berths	4 x 1, 3 x 2, 34 x 4 Berths
Total Pax	146

LIFE-SAVING EQUIPMENT

Life Rafts	6 x 25 Men, SOLAS Compliant
Rescue Boat c/w Davit	2 x 75 Men, 20.6 kW of Inboard Eng, 100 L, SOLAS Compliant

Particulars are believed to be correct but not guaranteed. Owners reserve the rights to amend the specifications without notifications. Particulars are entirely without warranty as to correctness and interested parties must inspect vessel's certificates, drawings or physical inspection of vessel.

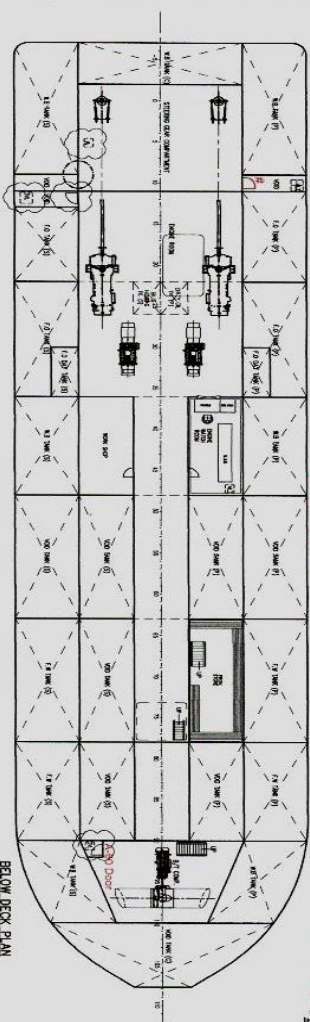

BELOW DECK PLAN

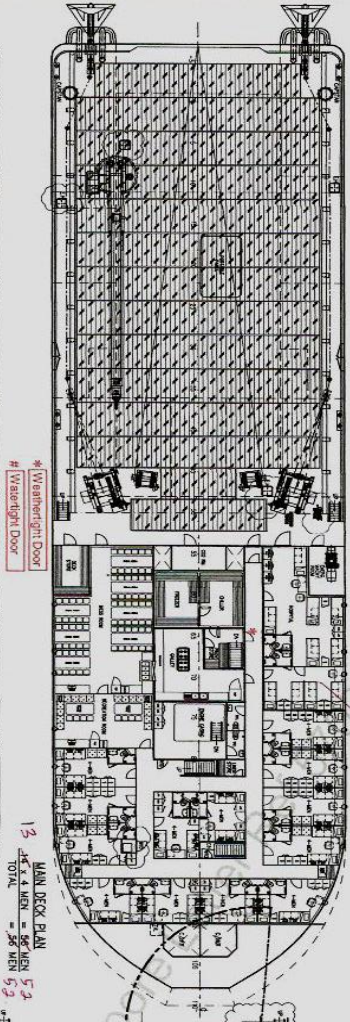

MAIN DECK PLAN
Ventilation Door
Washlight Door
13
42.41 METERS = 53 MEN
53

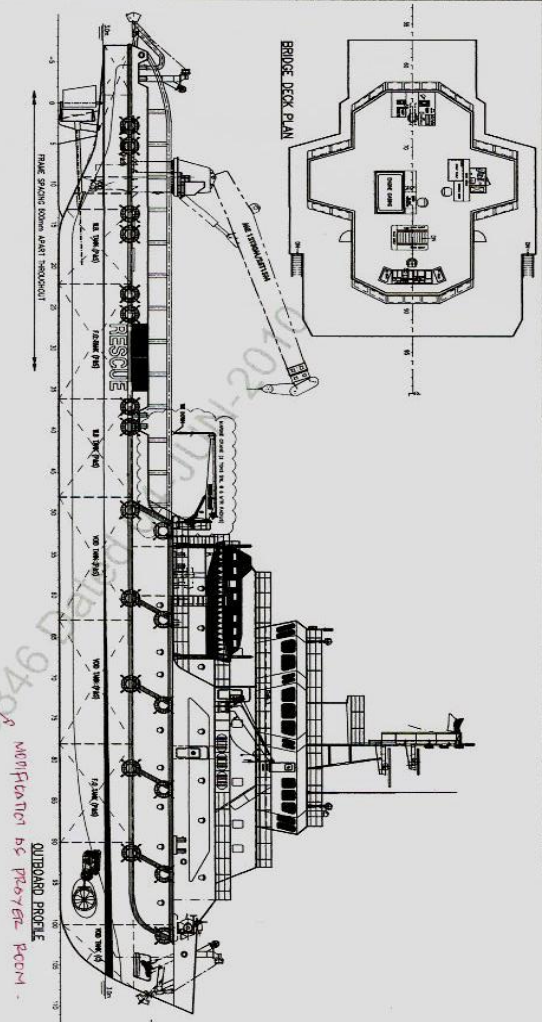

OUTBOARD PROFILE
MOTION NOT TO BE PROVIDED

REVIEWED BY: **ABS**

DATE: 15/04/2018

PROJECT: 70m MAINTENANCE/SUPPORT VESSEL

CLIENT: **KHIAN CHUAN MARINE PTE LTD**

12, HAYWARDS ROAD, SINGAPORE 653188

EMAIL: KHIAN@KHIANMARINE.COM

NO.	REVISION	DATE
1	ISSUED FOR CONSTRUCTION	15/04/2018
2	ISSUED FOR CONSTRUCTION	15/04/2018
3	ISSUED FOR CONSTRUCTION	15/04/2018
4	ISSUED FOR CONSTRUCTION	15/04/2018
5	ISSUED FOR CONSTRUCTION	15/04/2018
6	ISSUED FOR CONSTRUCTION	15/04/2018
7	ISSUED FOR CONSTRUCTION	15/04/2018
8	ISSUED FOR CONSTRUCTION	15/04/2018
9	ISSUED FOR CONSTRUCTION	15/04/2018
10	ISSUED FOR CONSTRUCTION	15/04/2018
11	ISSUED FOR CONSTRUCTION	15/04/2018
12	ISSUED FOR CONSTRUCTION	15/04/2018
13	ISSUED FOR CONSTRUCTION	15/04/2018
14	ISSUED FOR CONSTRUCTION	15/04/2018
15	ISSUED FOR CONSTRUCTION	15/04/2018
16	ISSUED FOR CONSTRUCTION	15/04/2018
17	ISSUED FOR CONSTRUCTION	15/04/2018
18	ISSUED FOR CONSTRUCTION	15/04/2018
19	ISSUED FOR CONSTRUCTION	15/04/2018
20	ISSUED FOR CONSTRUCTION	15/04/2018
21	ISSUED FOR CONSTRUCTION	15/04/2018
22	ISSUED FOR CONSTRUCTION	15/04/2018
23	ISSUED FOR CONSTRUCTION	15/04/2018
24	ISSUED FOR CONSTRUCTION	15/04/2018
25	ISSUED FOR CONSTRUCTION	15/04/2018
26	ISSUED FOR CONSTRUCTION	15/04/2018
27	ISSUED FOR CONSTRUCTION	15/04/2018
28	ISSUED FOR CONSTRUCTION	15/04/2018
29	ISSUED FOR CONSTRUCTION	15/04/2018
30	ISSUED FOR CONSTRUCTION	15/04/2018
31	ISSUED FOR CONSTRUCTION	15/04/2018
32	ISSUED FOR CONSTRUCTION	15/04/2018
33	ISSUED FOR CONSTRUCTION	15/04/2018
34	ISSUED FOR CONSTRUCTION	15/04/2018
35	ISSUED FOR CONSTRUCTION	15/04/2018
36	ISSUED FOR CONSTRUCTION	15/04/2018
37	ISSUED FOR CONSTRUCTION	15/04/2018
38	ISSUED FOR CONSTRUCTION	15/04/2018
39	ISSUED FOR CONSTRUCTION	15/04/2018
40	ISSUED FOR CONSTRUCTION	15/04/2018
41	ISSUED FOR CONSTRUCTION	15/04/2018
42	ISSUED FOR CONSTRUCTION	15/04/2018
43	ISSUED FOR CONSTRUCTION	15/04/2018
44	ISSUED FOR CONSTRUCTION	15/04/2018
45	ISSUED FOR CONSTRUCTION	15/04/2018
46	ISSUED FOR CONSTRUCTION	15/04/2018
47	ISSUED FOR CONSTRUCTION	15/04/2018
48	ISSUED FOR CONSTRUCTION	15/04/2018
49	ISSUED FOR CONSTRUCTION	15/04/2018
50	ISSUED FOR CONSTRUCTION	15/04/2018
51	ISSUED FOR CONSTRUCTION	15/04/2018
52	ISSUED FOR CONSTRUCTION	15/04/2018
53	ISSUED FOR CONSTRUCTION	15/04/2018
54	ISSUED FOR CONSTRUCTION	15/04/2018
55	ISSUED FOR CONSTRUCTION	15/04/2018
56	ISSUED FOR CONSTRUCTION	15/04/2018
57	ISSUED FOR CONSTRUCTION	15/04/2018
58	ISSUED FOR CONSTRUCTION	15/04/2018
59	ISSUED FOR CONSTRUCTION	15/04/2018
60	ISSUED FOR CONSTRUCTION	15/04/2018
61	ISSUED FOR CONSTRUCTION	15/04/2018
62	ISSUED FOR CONSTRUCTION	15/04/2018
63	ISSUED FOR CONSTRUCTION	15/04/2018
64	ISSUED FOR CONSTRUCTION	15/04/2018
65	ISSUED FOR CONSTRUCTION	15/04/2018
66	ISSUED FOR CONSTRUCTION	15/04/2018
67	ISSUED FOR CONSTRUCTION	15/04/2018
68	ISSUED FOR CONSTRUCTION	15/04/2018
69	ISSUED FOR CONSTRUCTION	15/04/2018
70	ISSUED FOR CONSTRUCTION	15/04/2018
71	ISSUED FOR CONSTRUCTION	15/04/2018
72	ISSUED FOR CONSTRUCTION	15/04/2018
73	ISSUED FOR CONSTRUCTION	15/04/2018
74	ISSUED FOR CONSTRUCTION	15/04/2018
75	ISSUED FOR CONSTRUCTION	15/04/2018
76	ISSUED FOR CONSTRUCTION	15/04/2018
77	ISSUED FOR CONSTRUCTION	15/04/2018
78	ISSUED FOR CONSTRUCTION	15/04/2018
79	ISSUED FOR CONSTRUCTION	15/04/2018
80	ISSUED FOR CONSTRUCTION	15/04/2018
81	ISSUED FOR CONSTRUCTION	15/04/2018
82	ISSUED FOR CONSTRUCTION	15/04/2018
83	ISSUED FOR CONSTRUCTION	15/04/2018
84	ISSUED FOR CONSTRUCTION	15/04/2018
85	ISSUED FOR CONSTRUCTION	15/04/2018
86	ISSUED FOR CONSTRUCTION	15/04/2018
87	ISSUED FOR CONSTRUCTION	15/04/2018
88	ISSUED FOR CONSTRUCTION	15/04/2018
89	ISSUED FOR CONSTRUCTION	15/04/2018
90	ISSUED FOR CONSTRUCTION	15/04/2018
91	ISSUED FOR CONSTRUCTION	15/04/2018
92	ISSUED FOR CONSTRUCTION	15/04/2018
93	ISSUED FOR CONSTRUCTION	15/04/2018
94	ISSUED FOR CONSTRUCTION	15/04/2018
95	ISSUED FOR CONSTRUCTION	15/04/2018
96	ISSUED FOR CONSTRUCTION	15/04/2018
97	ISSUED FOR CONSTRUCTION	15/04/2018
98	ISSUED FOR CONSTRUCTION	15/04/2018
99	ISSUED FOR CONSTRUCTION	15/04/2018
100	ISSUED FOR CONSTRUCTION	15/04/2018

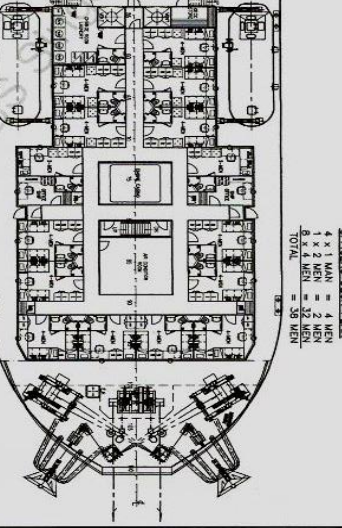

FORECASTLE DECK PLAN

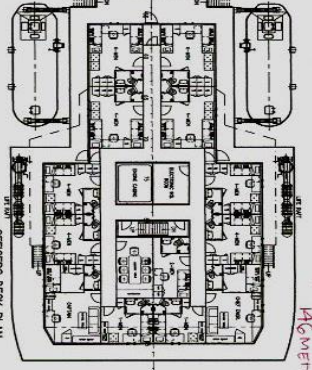

CREWS DECK PLAN
4 X 1 MAN = 4 MEN
8 X 2 MEN = 16 MEN
TOTAL = 20 MEN

PRINCIPAL DIMENSIONS

LENGTH (O/A)	70.160 M
LENGTH (S/S)	63.571 M
BEZEL (M/D)	19.520 M
DESIGN DRAUGHT	3.000 M
FUEL OIL	575 M ³
FRESH WATER	550 M ³
DECK CARGO AREA	500 M ²
DECK CARGO (DECK LOADING=7.07/M ²)	3535 TONS
MAIN PROPULSION ENGINE	2X1720 SHIPS
COMPLEMENT	150 MEN

AGMETH

MOSTER

THIS DOCUMENT AND THE INFORMATION CONTAINED HEREIN ARE THE PROPERTY OF KHIAN CHUAN MARINE PTE LTD. IT IS NOT TO BE REPRODUCED OR TRANSMITTED IN ANY FORM OR BY ANY MEANS, ELECTRONIC OR MECHANICAL, INCLUDING PHOTOCOPYING, RECORDING, OR BY ANY INFORMATION STORAGE AND RETRIEVAL SYSTEM.

GENERAL ARRANGEMENT

70m MAINTENANCE/SUPPORT VESSEL

PROJECT NO: 15188/15199

DATE: 15/04/2018

SCALE: AS SHOWN

DESIGNER: KHIAN CHUAN MARINE PTE LTD

12, HAYWARDS ROAD, SINGAPORE 653188

EMAIL: KHIAN@KHIANMARINE.COM

TEL: 65 6338 8888

FAX: 65 6338 8888

WEBSITE: WWW.KHIANMARINE.COM

REGISTRATION NO: 15188/15199

ISSUE NO: 1

DATE: 15/04/2018

SCALE: AS SHOWN

DESIGNER: KHIAN CHUAN MARINE PTE LTD

12, HAYWARDS ROAD, SINGAPORE 653188

EMAIL: KHIAN@KHIANMARINE.COM

TEL: 65 6338 8888

FAX: 65 6338 8888

WEBSITE: WWW.KHIANMARINE.COM

REGISTRATION NO: 15188/15199

ISSUE NO: 1

DATE: 15/04/2018

SCALE: AS SHOWN

DESIGNER: KHIAN CHUAN MARINE PTE LTD

12, HAYWARDS ROAD, SINGAPORE 653188

EMAIL: KHIAN@KHIANMARINE.COM

TEL: 65 6338 8888

FAX: 65 6338 8888

WEBSITE: WWW.KHIANMARINE.COM

REGISTRATION NO: 15188/15199

ISSUE NO: 1

DATE: 15/04/2018

SCALE: AS SHOWN

DESIGNER: KHIAN CHUAN MARINE PTE LTD

12, HAYWARDS ROAD, SINGAPORE 653188

EMAIL: KHIAN@KHIANMARINE.COM

TEL: 65 6338 8888

FAX: 65 6338 8888

WEBSITE: WWW.KHIANMARINE.COM

REGISTRATION NO: 15188/15199

ISSUE NO: 1

DATE: 15/04/2018