



Uniexpress 12

Fast Crewboat/ Utility Vessel

PRINCIPAL PARTICULARS

Year Built	2008
Place Built	Thailand
Design	36M Crew / Utility Vessel Marsun Co. Ltd.
Flag	Thailand
Length Overall	36.00 m
Length BP	32.50 m
Breadth Moulded	7.60 m
Depth Moulded	3.30 m
Draft (max)	1.70 m
Freeboard (SLL)	1.06 m
Class	BV
Notation	I,+HULL, +MACH, Crewboat / Cargo Utility Vessel, Unrestricted Navigation
GRT/ NRT	205.00 T/ 63.00 T
Deadweight	120.00 T

DECK PARTICULARS

Clear Deck Area	80.00 m ²
Deck Carrying Load	50.00 T
Deck Strength	2.00 T/m ²

PERFORMANCE

Maximum Speed	24 Knots @ 15 T/24 hrs @ 32 DWT
Economic Speed	18 Knots @ 9.2 T/24 hrs @ 32 DWT

PROPULSION SYSTEM

Main Engines	3 x Cummins KTA 38-M2, 1350 BHP @ 1950 RPM, Total 4050 BHP
Auxiliary Engines	2 x Cummins 6BT5.9, 80 kW @ 1500 RPM
Propellers	3 x Nickel-Aluminium Bronze 4-Blade propeller, Stone Marine
Steering Gear System	Duplex Electro Hydraulic Pump System
Rudder	2 Units

TANK CAPACITIES

Fuel Oil	69.80 m ³
Fresh Water	17.70 m ³

CARGO DISCHARGE CAPACITIES

Fuel Oil Pump	20 m ³ /hr @ 40 m Head, Azcue BT-IL52D3
Fresh Water Pump	1 x 20 m ³ /h, Azcue, CA-50-7 Ø185, 2900 RPM
Bilge	30 m ³ /hr, 30 m head, Azcue CA-50-7 Ø185

DECK EQUIPMENT

Anchor Windlass c/w Bow	Electro Hydraulic Winch c/w Wire Rope, Chain & Single Anchor
-------------------------	--

ACCOMMODATION

Passenger Seats	92
Crew	6



EXTERNAL FIRE-FIGHTING EQUIPMENT

Fi-Fi Notation	FAS
Fi-Fi Monitors	600 m ³ /hr, 100 m Throw Length
Fi-Fi Pump	600 m ³ /hr

INTERNAL FIRE-FIGHTING & ANTI-POLLUTION EQUIPMENT

Emergency Fire Pump	Azcue, CA50/7-A, S/N 341611, 30 m ³ /h
CO2 Fi-Fi System	Fixed CO2 System for Engine Room
Fire Detection & Alarm	Notifier: AFP-200 Smoke Detector/ Smoke with Heat Detector & Fire Alarm Bell

LIFE-SAVING EQUIPMENT

Life Rafts	8 x 25 men, SOLAS Compliant
------------	-----------------------------

Particulars are believed to be correct but not guaranteed. Owners reserve the rights to amend the specifications without notifications. Particulars are entirely without warranty as to correctness and interested parties must inspect vessel's certificates, drawings or physical inspection of vessel.

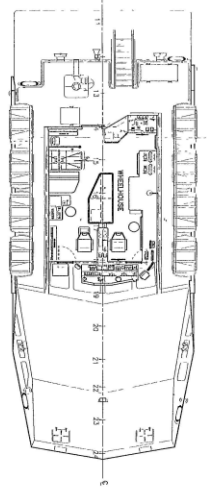

DECKHOUSE PLAN
SCALE 1:10

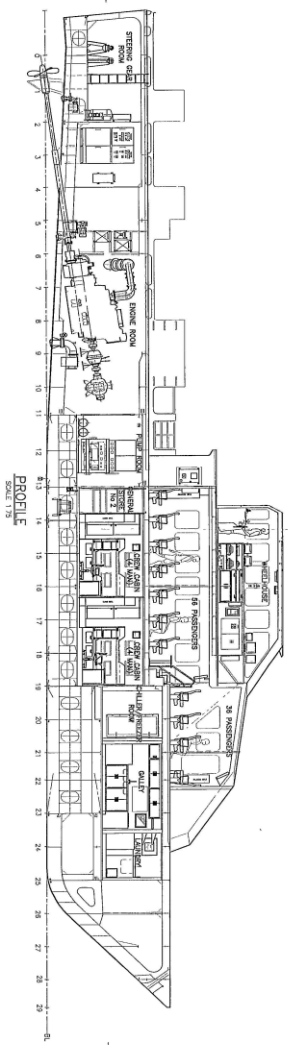

PROFILE
SCALE 1:10

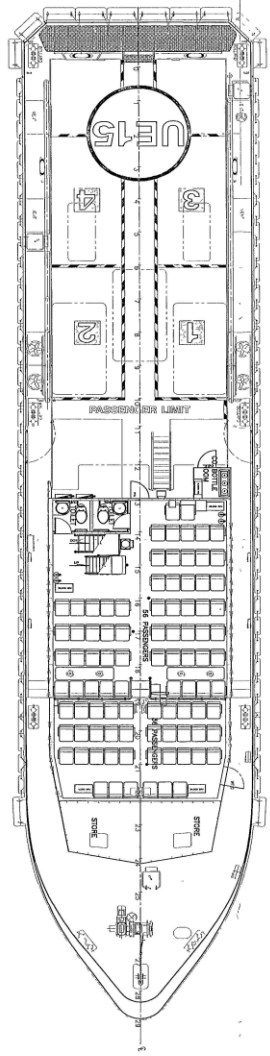

MAIN DECK
SCALE 1:75

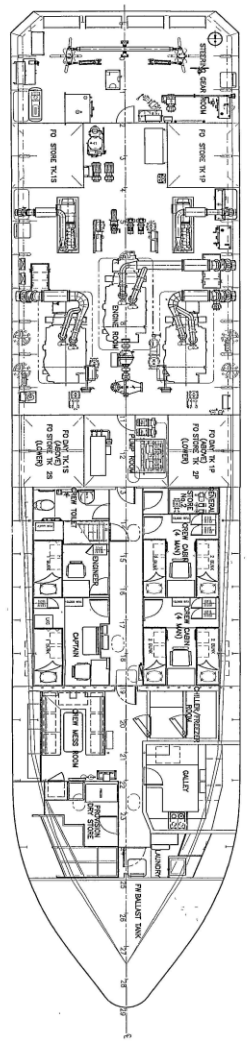

BELOW MAIN DECK
SCALE 1:75

MAIN CHARACTERISTICS

LENGTH OVER ALL	36.00	M
LENGTH WATERLINE	33.00	M
BREADTH MOULDED	7.60	M
DEPTH MOULDED	3.30	M
DRAFT (DESIGN)	1.25	M
DRAFT (LOADED)	1.70	M
COMPLEMENT	8	CREW
	92	PASSENGERS
FUEL OIL	50	Cu M
PORTABLE WATER	20	Cu M
CLEAR DECK SPACE	87	Sq M

NO.	1	2	3	4	5	6	7	8	9	10	11	12	13	14	15	16	17	18	19	20	21	22	23	24	25	26	27	28	29	30	31	32	33	34	35	36	37	38	39	40	41	42	43	44	45	46	47	48	49	50	51	52	53	54	55	56	57	58	59	60	61	62	63	64	65	66	67	68	69	70	71	72	73	74	75	76	77	78	79	80	81	82	83	84	85	86	87	88	89	90	91	92	93	94	95	96	97	98	99	100
NAME	UNIVERS OFFSHORE LIMITED																																																																																																			
DESIGNER	MARSIN COMPANY LIMITED																																																																																																			
OWNER	UNIVERS OFFSHORE LIMITED																																																																																																			
MANAGER	MARSIN COMPANY LIMITED																																																																																																			
OPERATOR	UNIVERS OFFSHORE LIMITED																																																																																																			
REGISTRY	LONDON																																																																																																			
CLASSIFICATION	LONDON																																																																																																			
TYPE	58 m CREW UTILITY VESSEL																																																																																																			
DATE	14/07/2011																																																																																																			
SCALE	1:75																																																																																																			

8119-4733/2532
 Marsin Company Limited
 111 Hill Street
 London, E14 6JG, UK

