

WHEELHOUSE DECK PLAN

PRINCIPAL PARTICULARS
 LENGTH O.A. 79.80m
 LENGTH W.L. 79.48m
 BEAM MLD. 20.40m
 DEPTH MLD. 8.00m
 DRAFT DESIGNED 5.50m
 COMPLEMENT 120 MEN

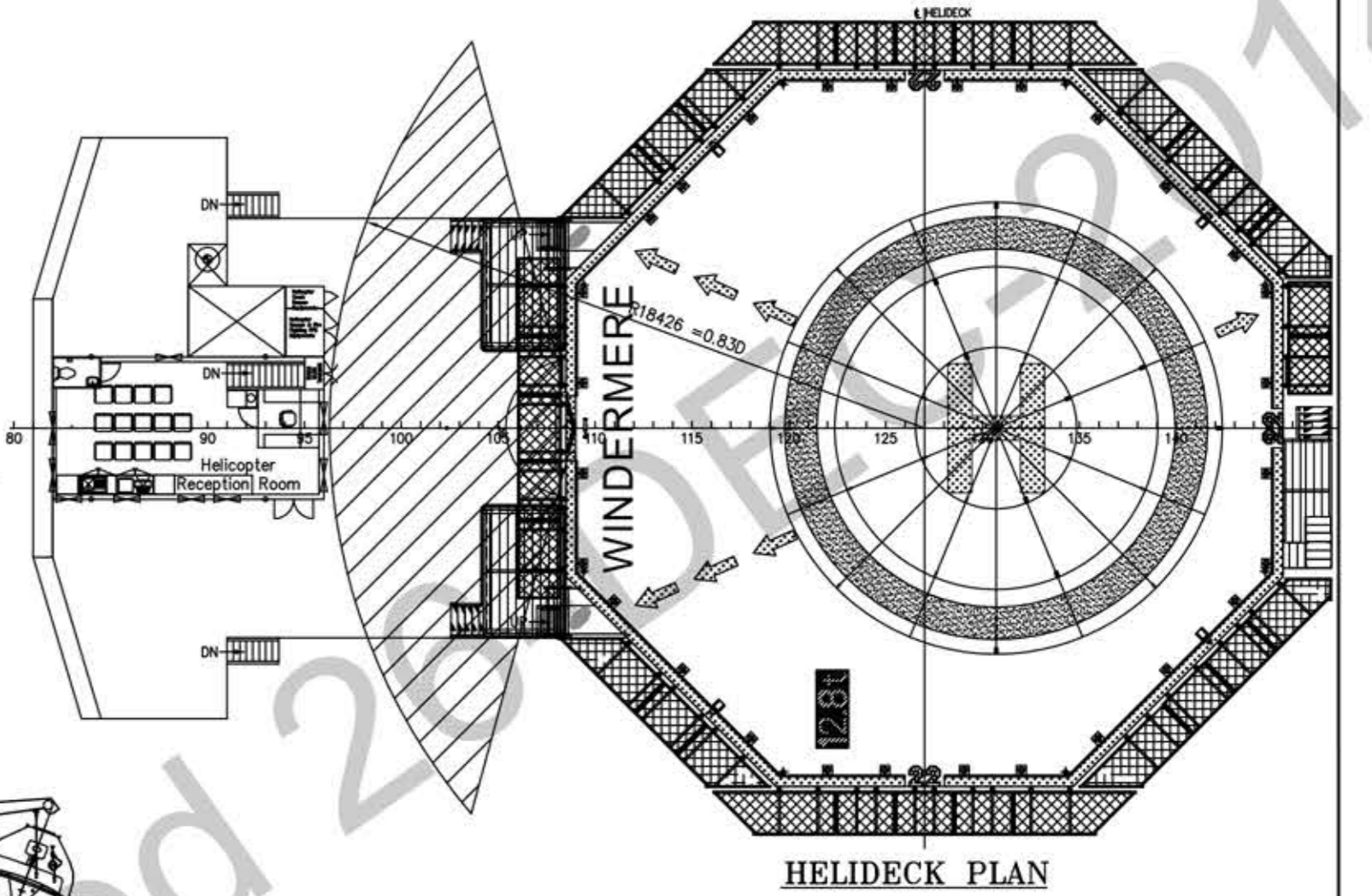

HELIDECK PLAN

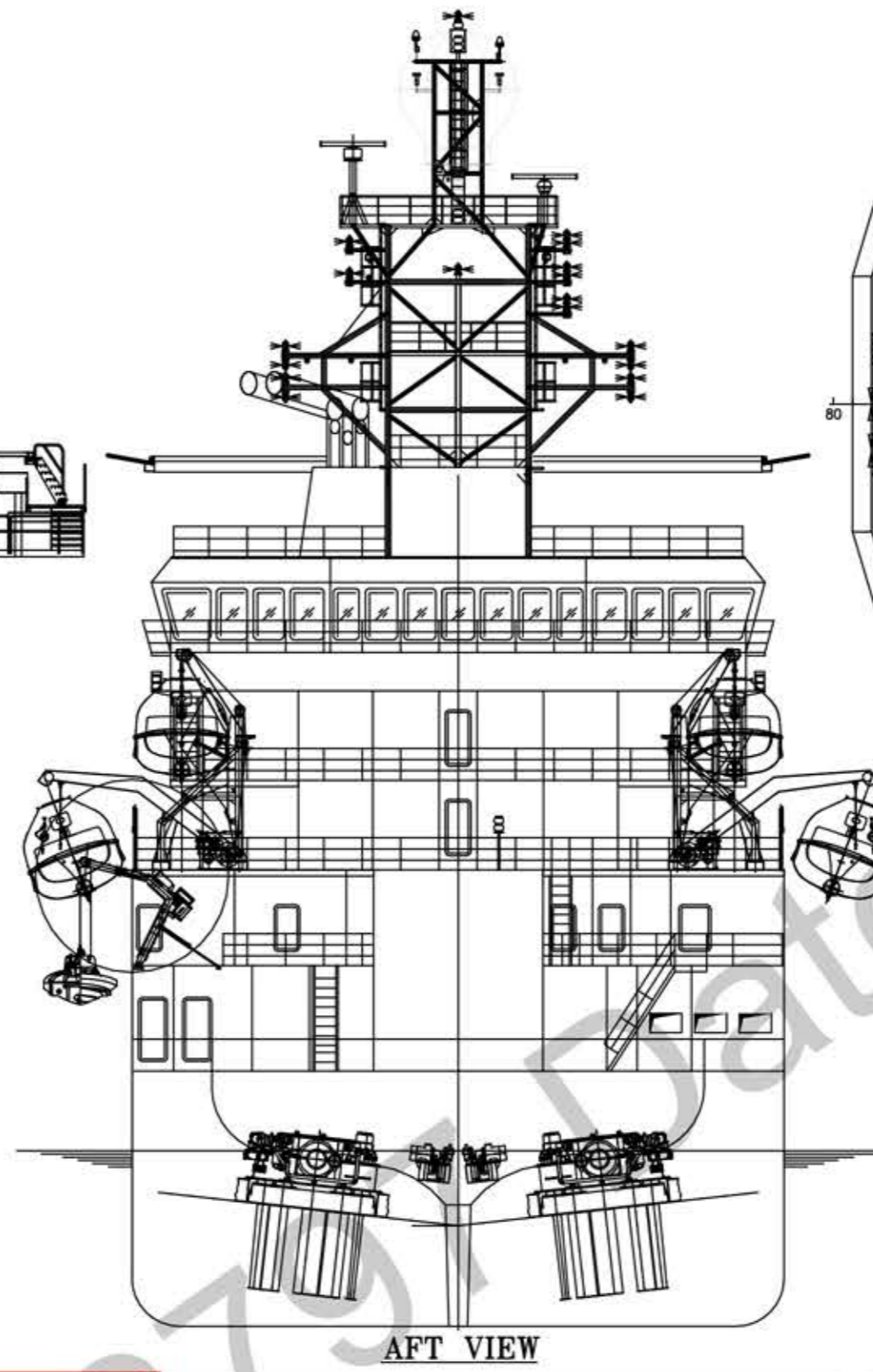
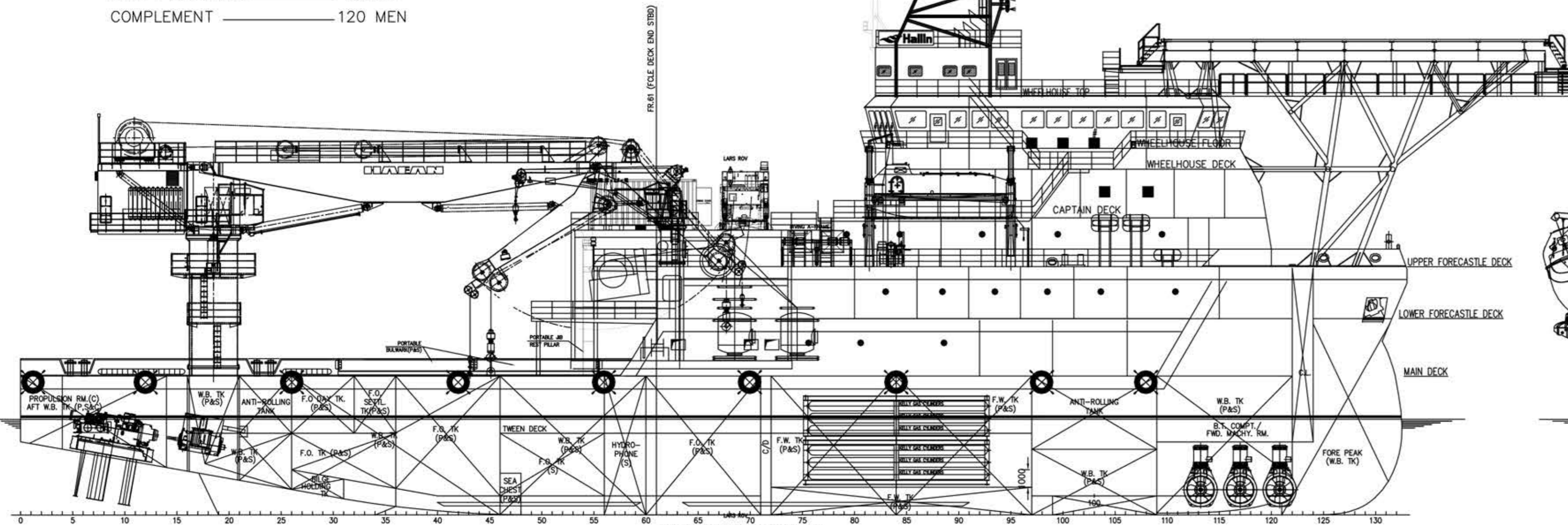
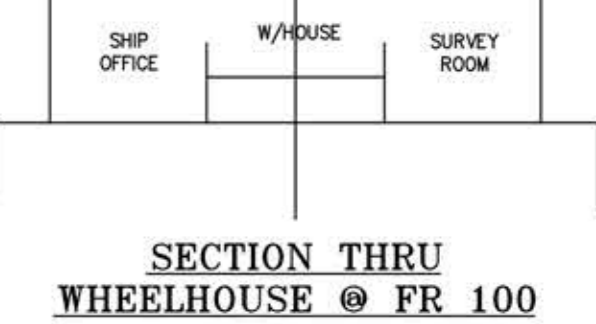

SECTION THRU WHEELHOUSE @ FR 100

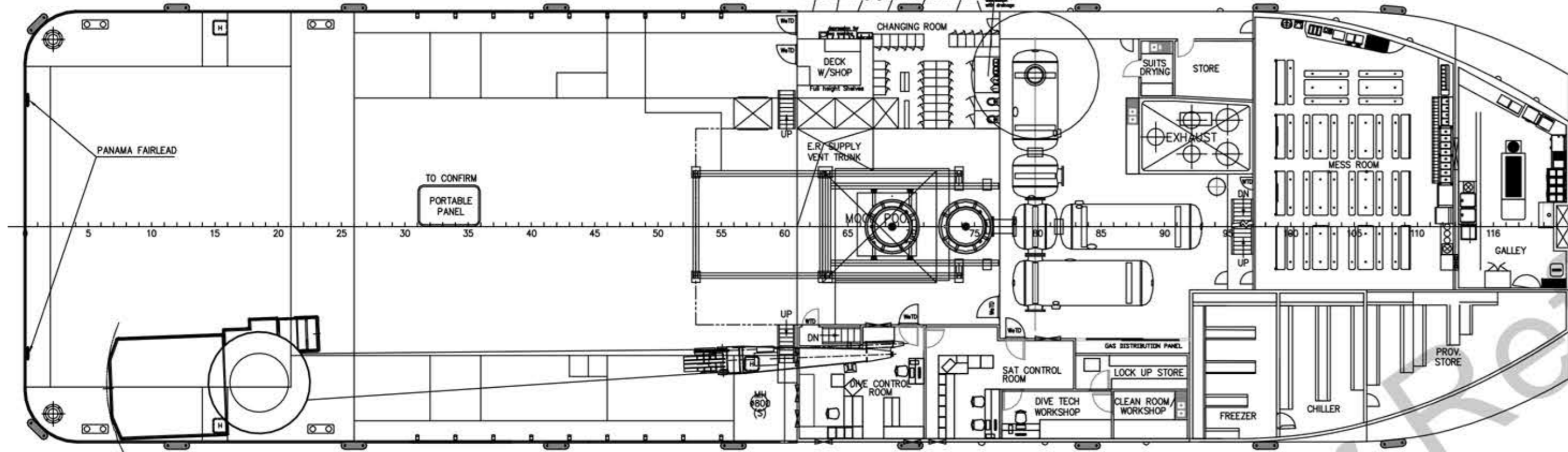

MAIN DECK PLAN

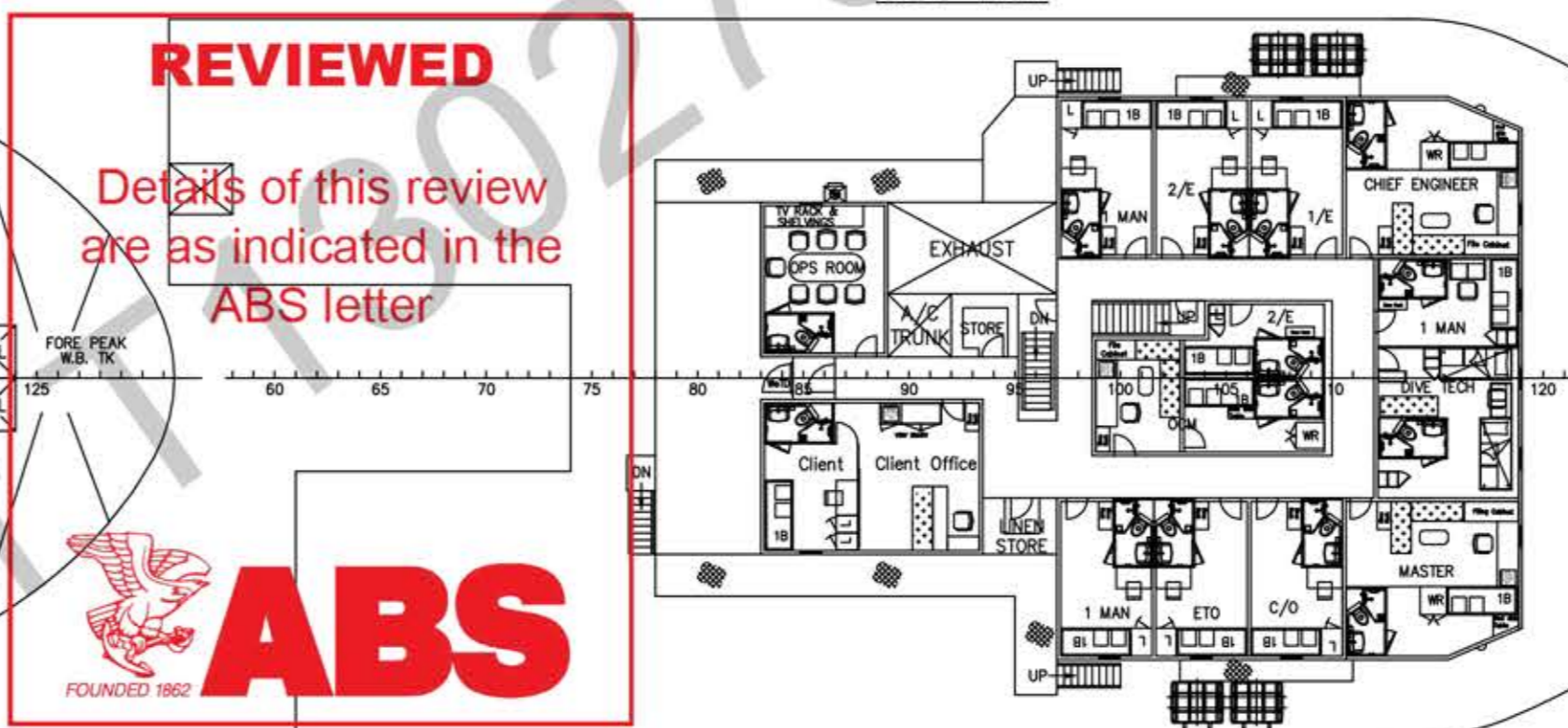

CAPTAIN'S DECK PLAN
 12 x 1 MAN = 12 MEN 1 x 2 MAN = 2 MEN
 TOTAL = 14 MEN

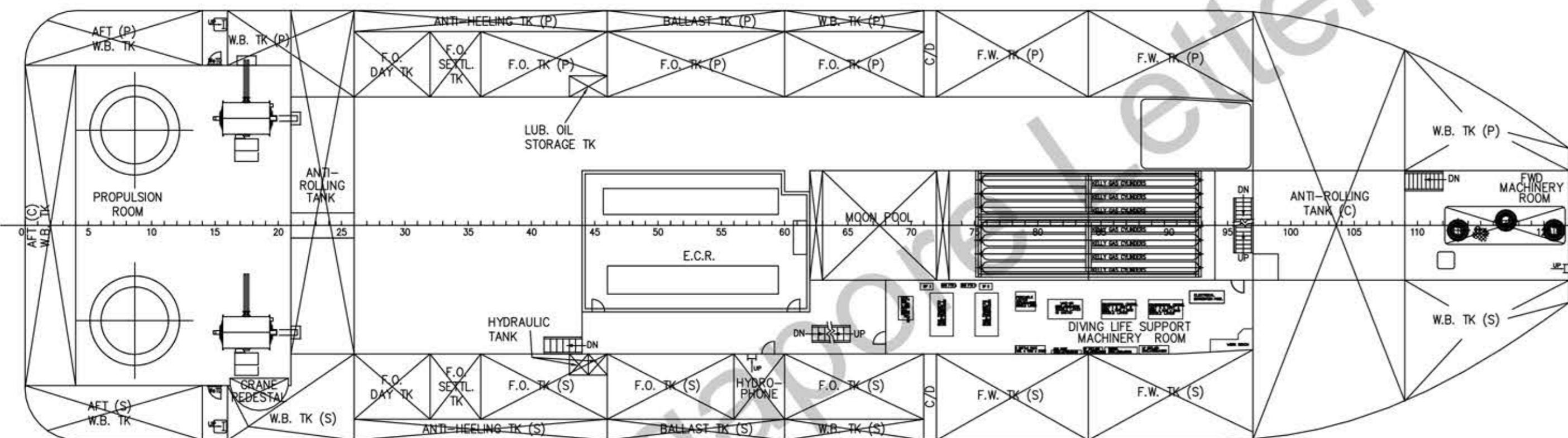
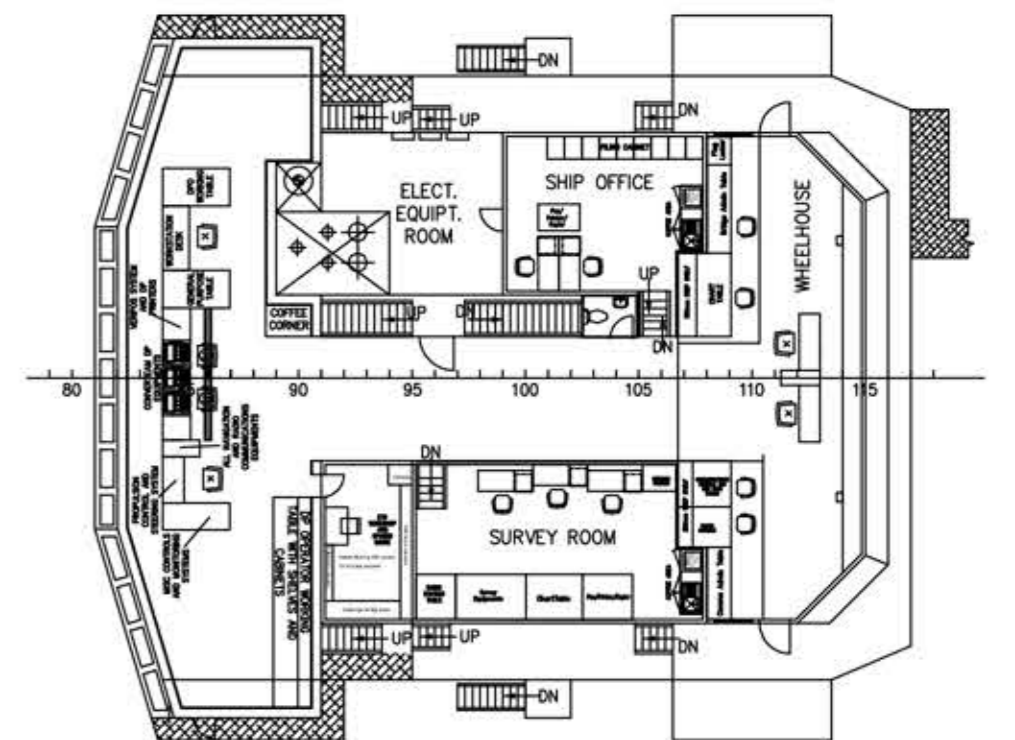

TWEEN DECK PLAN

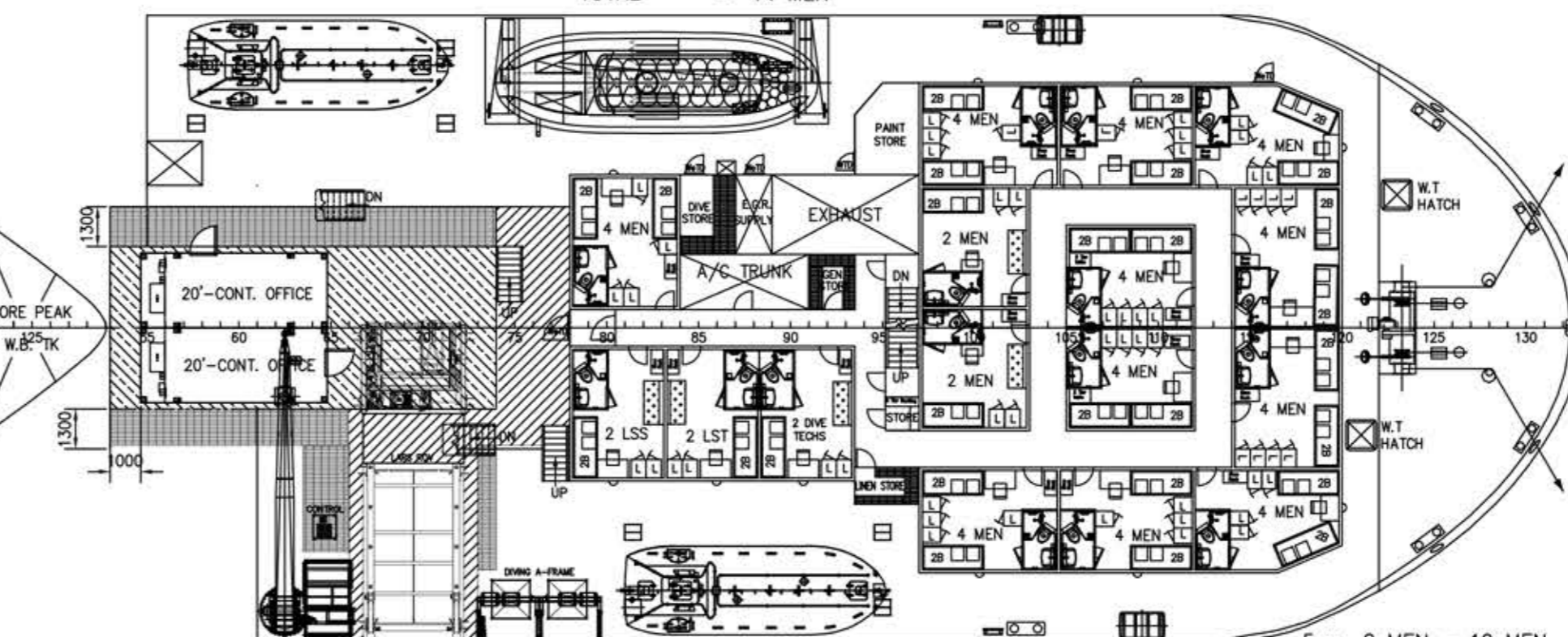

UPPER FORECASTLE DECK PLAN
 5 x 2 MEN = 10 MEN
 11 x 4 MEN = 44 MEN
 TOTAL = 54 MEN

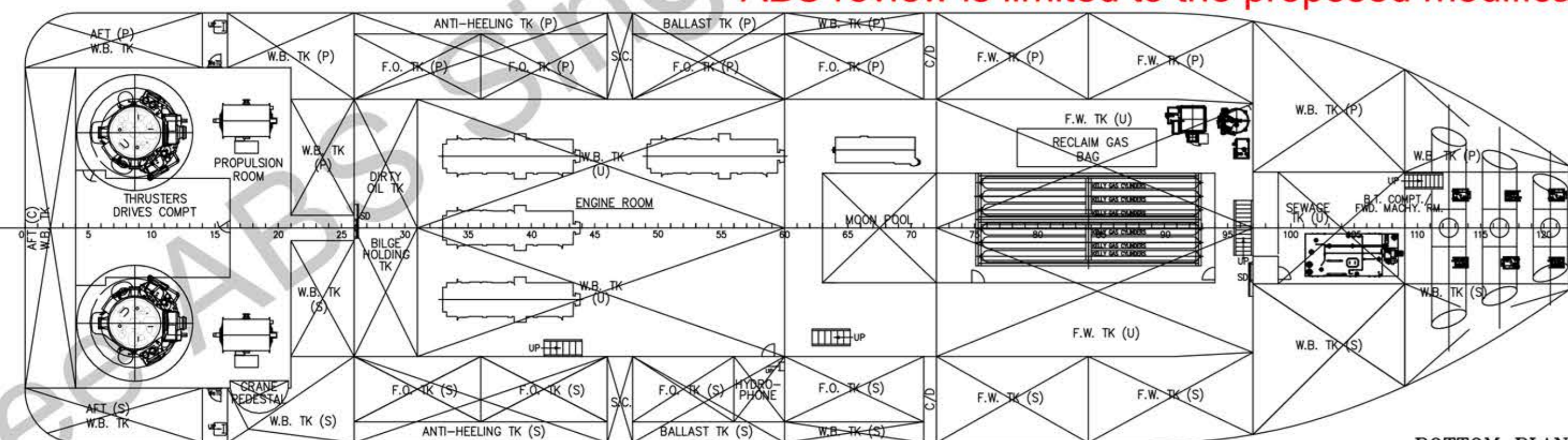

BOTTOM PLAN

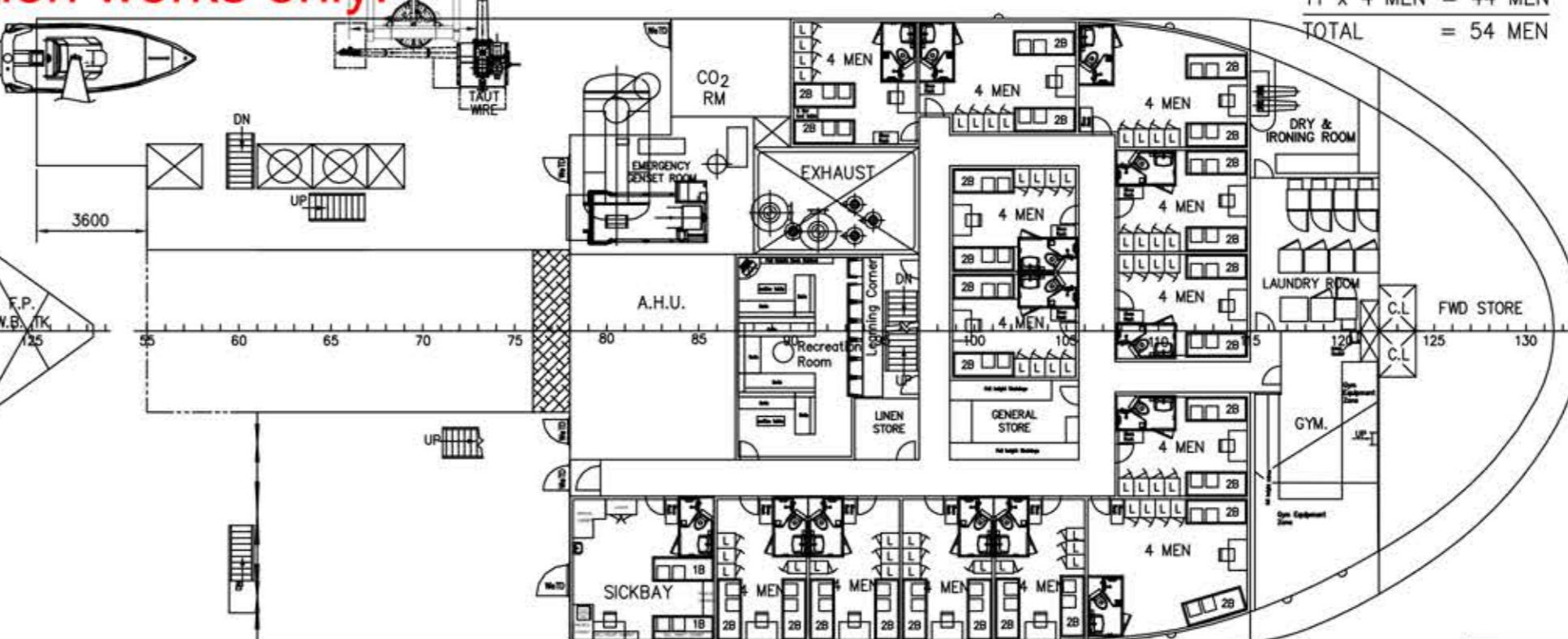

LOWER FORECASTLE DECK PLAN 13 x 4 MEN = 52 MEN

REVIEWED
 Details of this review are as indicated in the ABS letter

ABS review is limited to the proposed modification works only.

DATE	REV	MODIFICATION	BY
24.11.14	Q1	SEASCAPE REQUEST - ROW LARS PLATFORM EXTENSION	LR
3/3/14	Q	CONVERT DAVIT LAUNCH LIFECRAFT TO THROWAWAY, EXEMPTION GIVEN BY MARITIME AFFAIRS HONGKONG	OS
31.05.10	P	REVISED DRAWING ACCORDING TO AS BUILT CONDITION	DWS(W)
24.02.10	N	AMENDED AS PER OWNER'S COMMENTS	WILLIAM
05.01.10	M	AMENDED AS PER YARD'S COMMENTS	WILLIAM
19.11.09	L	AMENDED AS PER YARD'S COMMENTS	WILLIAM
28.08.09	K	AMENDED AS PER OWNER'S & YARD'S COMMENTS	WILLIAM
15.05.09	J	AMENDED AS PER OWNER'S COMMENTS & UPDATED VENDOR'S DWG	WILLIAM
24.03.09	I	AMENDED AS PER OWNER'S COMMENTS	WILLIAM
14.01.09	H	AMENDED AS PER DESIGN PROGRESS	WILLIAM
29.12.08	G	AMENDED AS PER PROPULSION ROOM & ENGINE ROOM ARR. AMENDED LOWER FORECASTLE HEIGHT FROM 3300 TO 3300 AMENDED NAVIGATION LIGHT ARR. AS PER UPDATED	WILLIAM
18.12.08	F	AMENDED AS PER YARD'S COMMENTS	WILLIAM
25.06.08	E	AMENDED AS PER YARD'S COMMENTS	WILLIAM
23.06.08	D	UPDATED AS PER OWNER'S DRAWING	WILLIAM
12.06.08	C	AMENDED AS PER OWNER'S COMMENTS	WILLIAM
29.05.08	B	ADD SECOND ESCAPE FOR B.T. COMPT. & AMENDED AS PER OWNER'S COMMENTS	WILLIAM
11.03.08	A	ADD INCINERATOR AS PER YARD'S COMMENTS	WILLIAM

SHIP: 80m DP2 SUBSEA OPERATION VESSEL

TITLE: General Arrangement

OWNER	Hallin Marine Systems Ltd	YARD NO.	196
BUILDER	Drydocks World-Singapore Pte Ltd		
CLASS	ABS		

CONAN WU & ASSOCIATES
 NAVAL ARCHITECTS
 SINGAPORE
 MEWAH BUILDING, LEVEL 3, 5 INTERNATIONAL BUSINESS PARK,
 JURONG EAST, SINGAPORE 609914
 TEL: (65) 6562-1138 FAX: (65) 6562-1238 / 6562-0123, E-MAIL: mol@cw.com.sg

CHINA
 JAO TONG BUILDING LEVEL-16, NO.831-2 TIBET ROAD(S), SHANGHAI 200011
 TEL: (86) 21-63679881/63676046 FAX: (86) 21-63677332, E-MAIL: mol@cw.com.sg

DRAWN	CHECKED	APPROVED	SCALE	DRAWING NO.	REV
Du	CHIA		1:200	C4374/G-1	Q
01-11-07	01-11-07				

THIS DRAWING AND THE INFORMATION CONTAINED HEREIN ARE SUPPLIED ON THE UNDERSTANDING THAT THEY ARE THE EXCLUSIVE PROPERTY OF CONAN WU & ASSOCIATES. THEY MUST NOT BE USED OR REPRODUCED IN WHOLE OR IN PART WITHOUT PERMISSION IN WRITING