



EXPRESS 66

Fast Utility Craft/ Crewboat

PRINCIPAL PARTICULARS

Year Built	2010
Place Built	Singapore
Design	Flex-36M, Penguin Shipyard Int'l
Flag	Malaysia
Length Overall	36.00 m
Length BP	33.20 m
Breadth Moulded	7.60 m
Depth Moulded	3.65 m
Draft (max)	1.88 m
Freeboard (SLL)	1.41 m
Class	BV
Notation	I, HULL, MACH, Crewboat, Sea Area 3, Max. Significant Wave Height Not Exceeding 3 m
GRT/ NRT	236.00 T / 71.00 T
Deadweight	114.00 T

DECK PARTICULARS

Clear Deck Area	80.00 m ²
Deck Carrying Load	40.00 T
Deck Strength	2.00 T/m ²

PERFORMANCE

Maximum Speed	25 Knots @ 16 T/24hrs
Economic Speed	23 Knots @ 14 T/24hrs

PROPULSION SYSTEM

Main Engines	3 x Cummins, KTA 38-M2, 1350 BHP, 1007 kW @ 1900 RPM, Total 4050 BHP
Auxiliary Engines	2 x Cummins 6BT5.9-DM, 80kW @ 1500 RPM
Portable Generator	Denko KDE3300E; Air-cooled Diesel Engine
Bow Thruster	45 kW Electro Hydraulic, 0.6 T
Propellers	3 x Fixed Pitch Propellers, 5-Blade
Steering Gear System	2 x Electro Hydraulic Ram
Rudder	2 x Balanced Rudder

TANK CAPACITIES

Fuel Oil	60.60 m ³ @ 95% fill
Fresh Water	28.10 m ³ @ 95% fill

DECK EQUIPMENT

Anchor Windlass c/w Bow	Hypac HHAW15-32
-------------------------	-----------------

ACCOMMODATION

Passenger Seats	70
Crew	2 x 1, 1 x 2, 1 x 4 = 8



EXTERNAL FIRE-FIGHTING EQUIPMENT

Fi-Fi Notation	Equivalent to 1/4 Fi-Fi System c/w Water Spray
Fi-Fi Monitors	600 m ³ /hr, 115 m Head
Fi-Fi Pump	600 m ³ /hr
Oil Dispersant System	V-jet Nozzles (P & S)

INTERNAL FIRE-FIGHTING & ANTI-POLLUTION EQUIPMENT

Emergency Fire Pump	Matsuka / Yanmar, 30 m ³ /hr @ 35m Head
CO2 Fi-Fi System	Fixed CO2 System for Engine room
Fire Detection & Alarm	ARMSTRONG M800 for Living Space & Engine Room

LIFE-SAVING EQUIPMENT

Life Rafts	6 x 25, 2 x 10 men, SOLAS Compliant
Rescue Boat c/w Davit	1 x 6 men, 25 HP Outboard Engine, Non-SOLAS Compliant

PRINCIPAL PARTICULARS

LENGTH O.A.	36.00 M
LENGTH B.P.	33.20 M
BREADTH MLD.	7.60 M
DEPTH MLD.	3.65 M
DESIGN DRAFT	1.88 M
COMPLEMENT	8 CREWS 70 OFFSHORE WORKERS

PROFILE

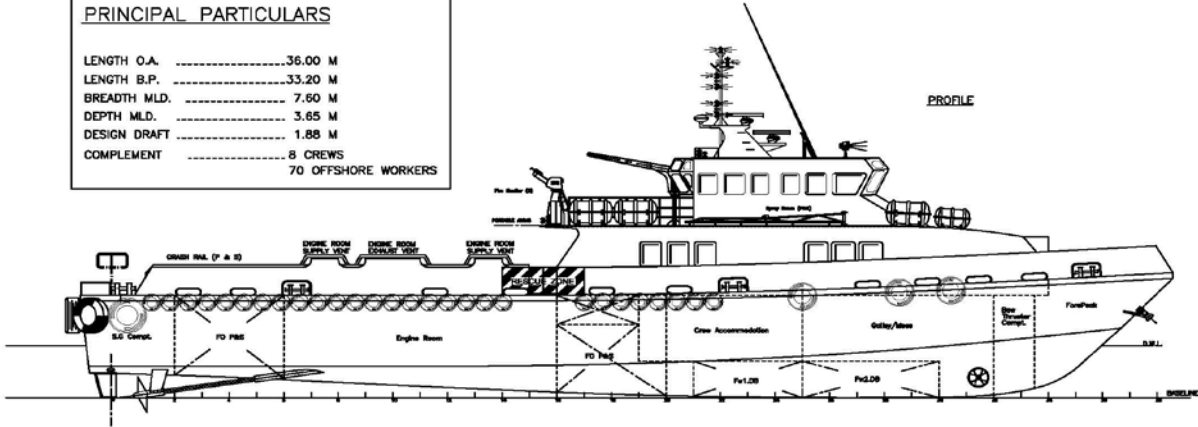

WHEELHOUSE TOP

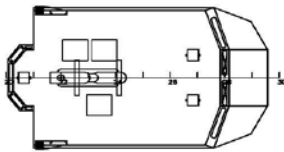

WHEELHOUSE PLAN

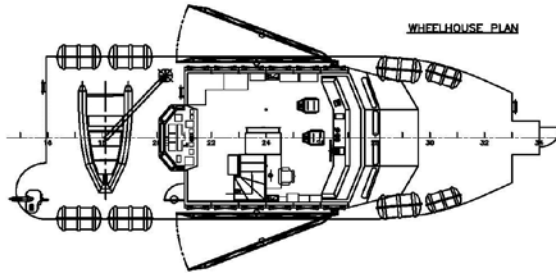

MAIN DECK

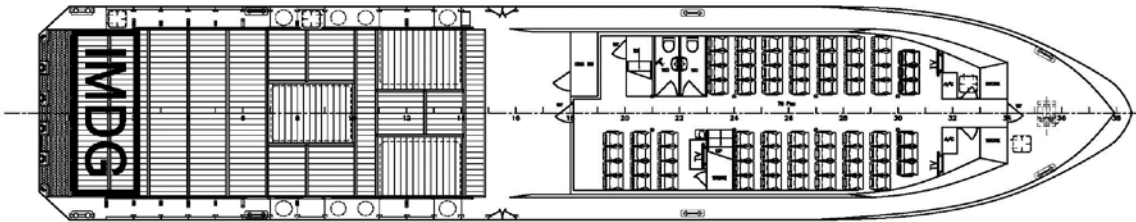

BELOW MAIN DECK

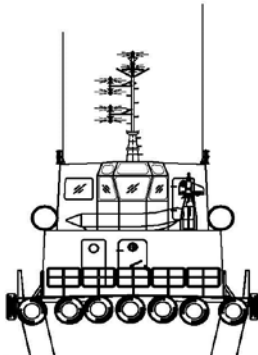
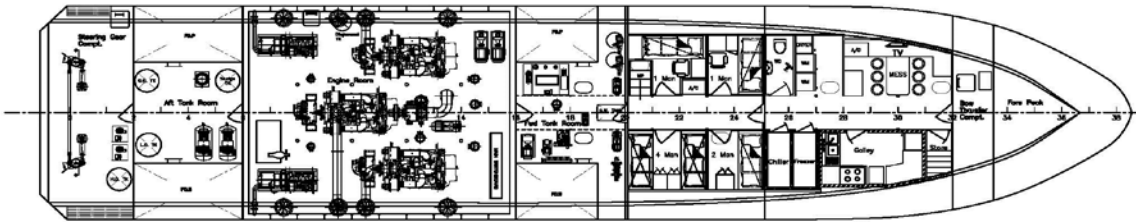

STERN VIEW

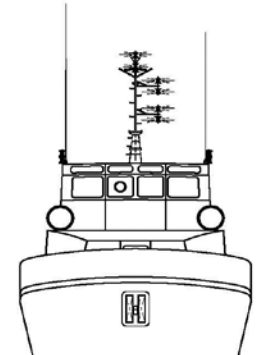

FRONT VIEW

B	Rearrange Galley/Mess Room & Crew Accommodation	20,APR,2011	ZH	Owner Request
Rev	Modification	Date	Done	Remark
PROJECT: 36M CREW BOAT (H172)				
TITLE: GENERAL ARRANGEMENT				
PENGUIN SHIPYARD INTERNATIONAL PTE LTD 18 Teck Siah Link, Singapore 63076 Tel: 68623272 Fax: 68622130				
DRAWN: ZH	DATE: 04,MAR,2010	SCALE: 1/75 (A1)		
CHECKED: PATRICK	DATE: 04,MAR,2010	REVISION: B		
DRAWING No: PBL-H168-G-01				SHEET: 1 OF 1