



EXPRESS 72

Fast Utility Craft/ Crewboat

PRINCIPAL PARTICULARS

| | |
|-----------------|---|
| Year Built | 2012 |
| Place Built | Indonesia, Batam |
| Design | Penguin Shipyard Int'l |
| Flag | Panama |
| Length Overall | 38.00 m |
| Length BP | 33.20 m |
| Breadth Moulded | 7.60 m |
| Depth Moulded | 3.65 m |
| Draft (max) | 1.89 m |
| Freeboard (SLL) | 1.81 m |
| Class | BV |
| Notation | I +HULL +MACH, Crewboat, Unrestricted navigation, Max significant wave ht 3.0 m |
| GRT/ NRT | 239.00 T / 71.00 T |
| Deadweight | 123.97 T |

DECK PARTICULARS

| | |
|--------------------|-----------------------|
| Clear Deck Area | 80.00 m ² |
| Deck Carrying Load | 55.00 T |
| Deck Strength | 2.00 T/m ² |

PERFORMANCE

| | |
|----------------|-----------------------|
| Maximum Speed | 27 Knots @ 16 T/24hrs |
| Economic Speed | 25 Knots @ 14 T/24hrs |

PROPULSION SYSTEM

| | |
|----------------------|--|
| Main Engines | 3 x Cummins KTA 38-M2, 1350 BHP, 1007 kW @ 1900RPM, Total 4050 BHP |
| Auxiliary Engines | 3 x Cummins 6BT5.9-DM1, 80 kW @ 1500 RPM |
| Portable Generator | Denko KDE 3300 |
| Emergency Generator | Nil |
| Bow Thruster | 75 HMM-650, 0.9 T Thrust |
| Propellers | 3 x Fixed Pitch Propellers |
| Steering Gear System | 2 x NUFOSS Pump |
| Rudder | 2 Units |

TANK CAPACITIES

| | |
|-------------|----------------------|
| Fuel Oil | 65.00 m ³ |
| Fresh Water | 30.00 m ³ |

CARGO DISCHARGE CAPACITIES

| | |
|------------------|--|
| Fuel Oil Pump | 23 m ³ /hr, TECO 7.5 HP, 5.5 kW |
| Fresh Water Pump | Marathon 5 KC39RN114GT 3/4 HP |
| Bilge | Nil |

DECK EQUIPMENT

| | |
|-------------------------|------------------------------|
| Anchor Windlass c/w Bow | HYPAC, HHAW 15-32 415V, 4 kW |
|-------------------------|------------------------------|



ACCOMMODATION

| | |
|-----------------|------------------------|
| Passenger Seats | 90 |
| Crew | 2 x 1, 1x 2, 1 x 4 = 8 |

EXTERNAL FIRE-FIGHTING EQUIPMENT

| | |
|-----------------------|---|
| Fi-Fi Notation | Equivalent to 1/4 Fi-Fi c/w Water Spray System |
| Fi-Fi Monitors | 600 m ³ /h, 100 m Throw Length, FFS600LB |
| Fi-Fi Pump | 600 m ³ /hr @ 100m, 250x350xP |
| Oil Dispersant System | Proportion Pump, 200 L |

INTERNAL FIRE-FIGHTING & ANTI-POLLUTION EQUIPMENT

| | |
|------------------------|--|
| Emergency Fire Pump | YanMar YDP 20E, 30m ³ /hr @ 35 m head |
| CO2 Fi-Fi System | Fixed CO2 System for Engine Room |
| Fire Detection & Alarm | Apollo |

LIFE-SAVING EQUIPMENT

| | |
|-----------------------|--|
| Life Rafts | 4 x 10, 8 x 25 men |
| Rescue Boat c/w Davit | 1 x 6 Aquamar, 380 ksm inflatable workboat with 25 HP outboard motor |

MAIN PARTICULARS:

LENGTH O.A.: 38.00 M
 LENGTH B.P.: 38.00 M
 BREADTH MLD.: 7.60 M
 DEPTH MLD.: 3.65 M
 DESIGN DRAFT: 1.890 M
 COMPLEMENT: 8 CREW MEMBERS
 90 OFFSHORE WORKERS

Class Notation: ABS +A1 HSC CREWBOAT
 RESTRICTED SERVICE +AMS

Drawing is being extended to cover
 PENGUIN SHIPYARD - H193195
 According to extension approval letter
 LA1958066 dated 30 OCT 2012

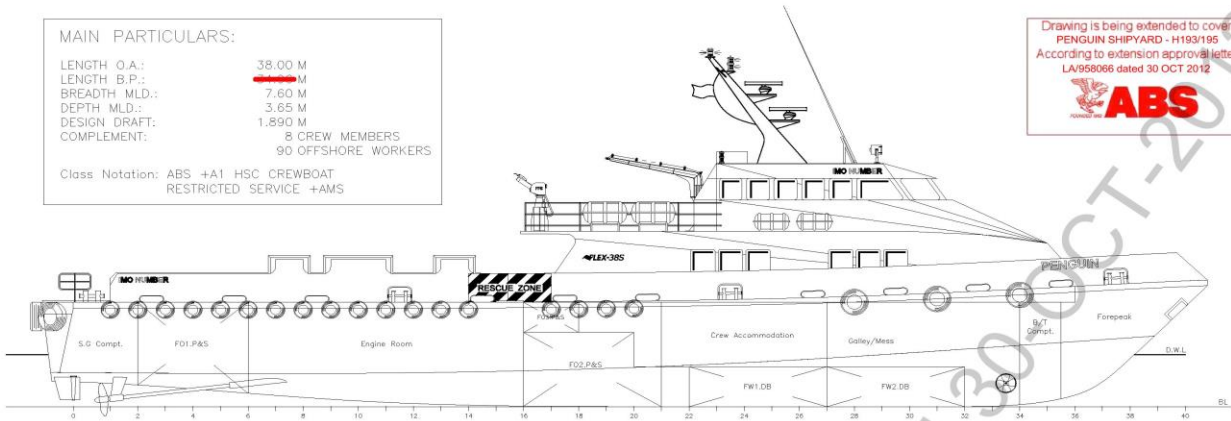
PROFILE

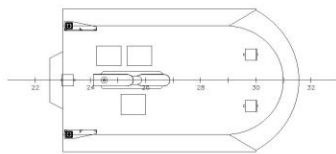

WHEELHOUSE TOP

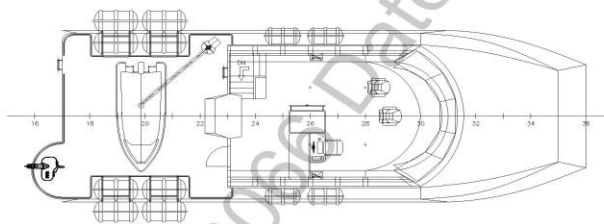

WHEELHOUSE PLAN

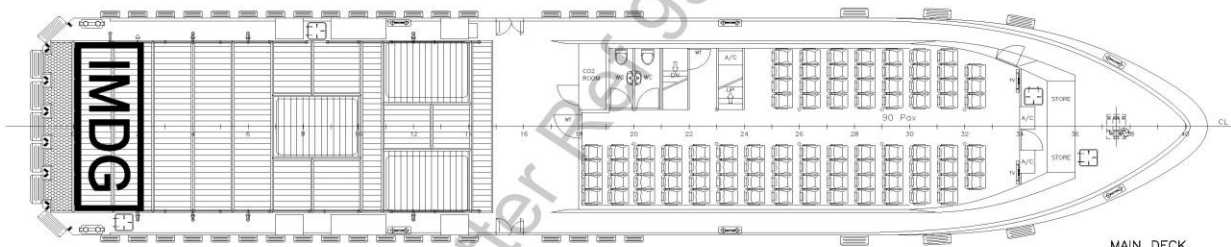

MAIN DECK

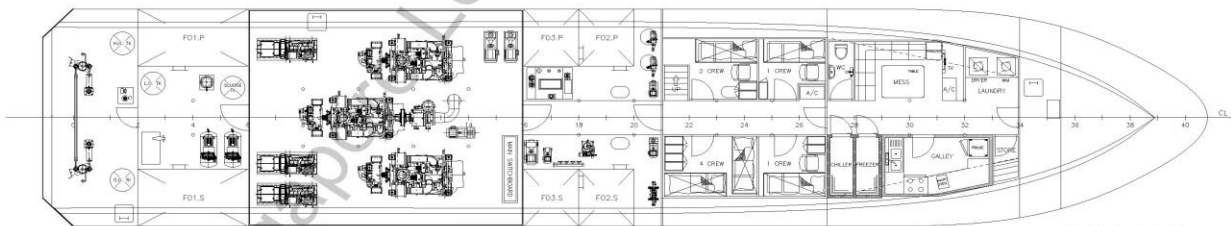

BELOW MAIN DECK

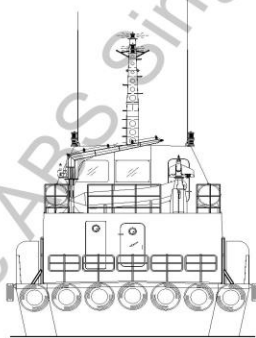

STERN VIEW

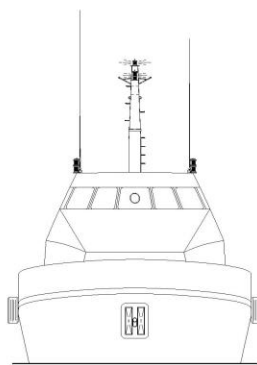

FRONT VIEW

REVIEWED
 Details of this review
 are as indicated in the
 ABS Letter



- DOOR AT FR.34, BELOW MAIN DECK,
 TO OPEN IN DIRECTION OF ESCAPE.
 - EFFICIENT MEANS OF DRAINAGE TO BE
 PROVIDED FOR DECKHOUSE AT MAIN DECK.

PROJECT: FLEX-3BS(H187-188)

TITLE: GENERAL ARRANGEMENT



PENGUIN SHIPYARD INTERNATIONAL PTE LTD

18 Tuas Basin Link, Singapore 638784 Tel: 68628522 Fax: 68622150

This drawing and the information contained herein is supplied on the understanding that they are the exclusive property of Penguin Shipyard International Pte Ltd. They must not be used or reproduced in whole or in part, without permission in writing.

| | | |
|----------------------------|-------------------|---------------|
| DRAWN: ZH | DATE: 01.AUG.2011 | SIZE: A1 |
| CHECKED: PATRICK | DATE: 08.AUG.2011 | SCALE: 1:75 |
| APPROVED: PATRICK | DATE: 20.AUG.2011 | REVISION: A |
| DRAWING No.: PSI-H191-G-01 | | SHEET: 1 OF 1 |