



EXPRESS 59

Fast Utility Craft/ Crewboat

PRINCIPAL PARTICULARS

Year Built	2007
Place Built	Singapore
Design	FLEX 36, Penguin Shipyard Int
Flag	Singapore
Length Overall	36.00 m
Length BP	32.20 m
Breadth Moulded	7.60 m
Depth Moulded	3.65 m
Draft (max)	1.88 m
Freeboard (SLL)	1.97 m
Class	BV
Notation	I + HULL MACH + Crewboat, Cargo Utility Vessel Coastal Area
GRT/ NRT	239.00 T / 73.00 T
Deadweight	113.00 T

DECK PARTICULARS

Clear Deck Area	80.00 m ²
Deck Carrying Load	40.00 T
Deck Strength	2.00 T/m ²

PERFORMANCE

Maximum Speed	22 Knots @ 20 T DWT
Economic Speed	18 Knots @ 20 T DWT

PROPULSION SYSTEM

Main Engines	3 x Cummins x KTA 38 M2, 1350 BHP, 1900 RPM, Total 4050 BHP, 2982 kW
Auxiliary Engines	2 x Cummins 6BT5.9-D(M), 80 kW @ 50 Hz
Portable Generator	Nil
Bow Thruster	75 kW Electro Hydraulic Bow Thruster, 75 kW, 1475 RPM
Propellers	3 x Fixed Pitch Propellers, 4-Bladed
Steering Gear System	2 x Duplex Electro Hydraulic Pump System
Rudder	2 Units

TANK CAPACITIES

Fuel Oil	52.80 m ³
Fresh Water	27.19 m ³

CARGO DISCHARGE CAPACITIES

Fuel Oil Pump	30 m ³ /hr
Fresh Water Pump	30 m ³ /hr
Bilge	25 m ³ /hr

DECK EQUIPMENT

Anchor Windlass c/w Bow	Single Anchor c/w Winch, Chain & Wire Rope
-------------------------	--



ACCOMMODATION

Passenger Seats	Nil
Crew	2 x 4, 1 x 2, 2 x 1, 2 x 4 = 20

EXTERNAL FIRE-FIGHTING EQUIPMENT

Fi-Fi Notation	Equivalent to 1/4 FiFi
Fi-Fi Monitors	600 m ³ /hr, 130 m Throw Length
Fi-Fi Pump	600 m ³ /hr (GM12V-71T1 Engine)
Oil Dispersant System	Nil

INTERNAL FIRE-FIGHTING & ANTI-POLLUTION EQUIPMENT

Emergency Fire Pump	Emergency Fire Pump
CO2 Fi-Fi System	Fixed CO2 System for Engine Room
Fire Detection & Alarm	Optical Smoke, Multi-Sensor Smoke & Heat Detector

LIFE-SAVING EQUIPMENT

Life Rafts	2 x 25 men, SOLAS Compliant
------------	-----------------------------

PRINCIPAL PARTICULARS

LENGTH O.A.	36.00 M
LENGTH B.P.	33.20 M
BREADTH MLD.	7.60 M
DEPTH MLD.	3.65 M
DESIGN DRAFT	1.88 M
COMPLEMENT	10 CREWS 10 OFF-PASSENGERS

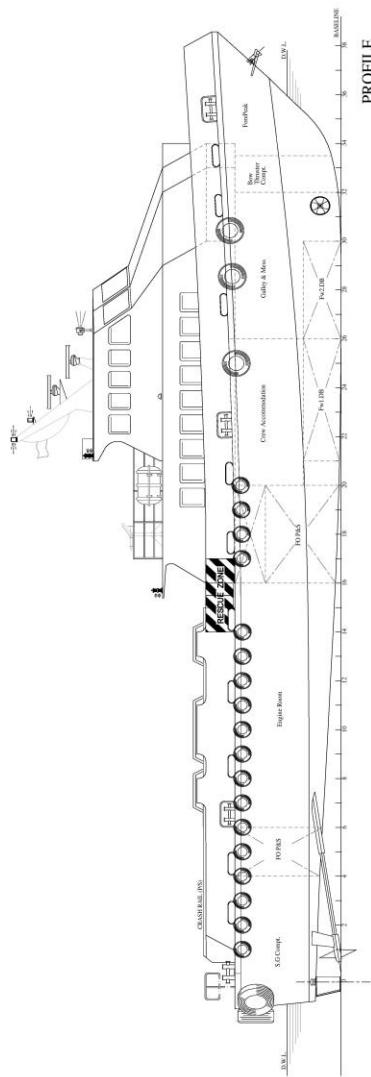

PROFILE

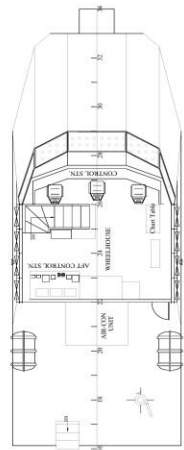

WHEELHOUSE PLAN

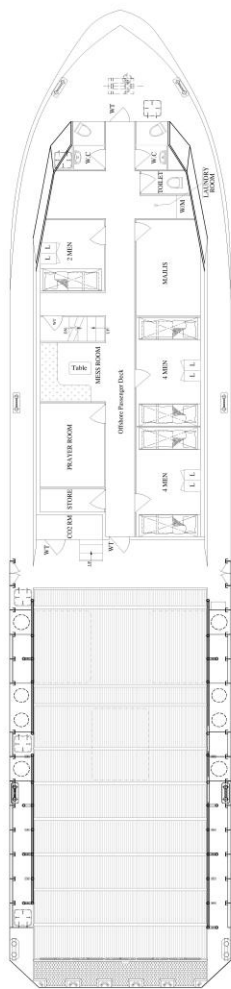

MAIN DECK

24 MEN + 8 WOMEN
TOTAL = 32 MEN (OFF-PASS)

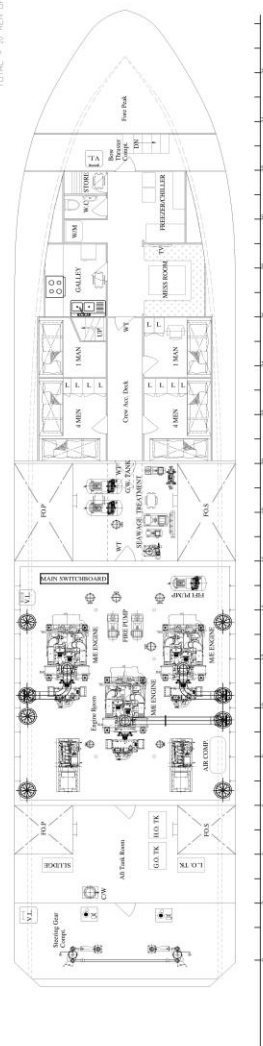

BELOW MAIN DECK

24 MEN + 8 WOMEN
TOTAL = 32 MEN (OFF-PASS)

AS-BUILT GENERAL ARRANGEMENT	C	LJR	DCT	16.04.14
REVISION GENERAL ARRANGEMENT	B	PT	DM	16.03.05
AS-BUILT GENERAL ARRANGEMENT	A	-	DM	-
DESCRIPTION	REV	DRN BY	CHK BY	DATE
CLIENT: MICLYN EXPRESS OFFSHORE				
TITLE: GENERAL ARRANGEMENT PLAN				
SHIP NAME: EXPRESS 59				
CONTRACT NO:	MEO GROUP O&P 001			
DRAWN:	LJR	SCALE:	1:1	
CHECKED:	DM	SHEET NO:	1 OF 1	
DATE:	16 APR 2014	DATE:	16 APR 2014	
www.miclynexpressoffshore.com				

