



EKSPRES 71

Fast Utility Craft/ Crewboat

PRINCIPAL PARTICULARS

Year Built	2011
Place Built	Singapore
Design	Penguin Shipyard Int'l
Flag	Malaysia
Length Overall	36.00 m
Length BP	33.20 m
Breadth Moulded	7.60 m
Depth Moulded	3.65 m
Draft (max)	1.78 m
Freeboard (SLL)	1.41 m
Class	BV
Notation	I, + Hull, + Mach, Crewboat, Urestricted navigation, Max Significant Wave ht 3.0 m
GRT/ NRT	236.00 T / 71.00 T
Deadweight	114.00 T

DECK PARTICULARS

Clear Deck Area	80.00 m ²
Deck Carrying Load	40.00 T
Deck Strength	2.00 T/m ²

PERFORMANCE

Maximum Speed	25 Knots @ 16 T/24 hrs
Economic Speed	23 Knots @ 14 T/24 hrs @ 31 DWT

PROPULSION SYSTEM

Main Engines	3 x Cummins KTA 38 M2, 1350 BHP, 1007 kW @ 1800 RPM, Total 4050 BHP
Auxiliary Engines	2 x Cummins 6BT 5.9, 80 kW @ 1500 RPM
Portable Generator	KDE3300E Diesel Gen, 3.6 kW @ 1200 RPM
Bow Thruster	45 kW, 0.6 T Thrust
Propellers	3 x Fixed Pitch Propellers
Steering Gear System	2 x Hydraulic
Rudder	2 x Hydraulic

TANK CAPACITIES

Fuel Oil	60.00 m ³
Fresh Water	28 m ³ @ 95% fill

DECK EQUIPMENT

Anchor Windlass c/w Bow	NX2057436, A/HHAW 15-32
-------------------------	-------------------------

ACCOMMODATION

Passenger Seats	70
Crew	2 x 1, 1 x 2, 1 x 4 = 8



EXTERNAL FIRE-FIGHTING EQUIPMENT

Fi-Fi Notation	SFP 250 x 350
Fi-Fi Monitors	1/4 Fi-Fi, 600 m ³ /hr @ 130 m head
Fi-Fi Pump	600 m ³ /hr @ 130 m head
Oil Dispersant System	Nil

INTERNAL FIRE-FIGHTING & ANTI-POLLUTION EQUIPMENT

Emergency Fire Pump	KIPOR Model, KM170F engine
CO2 Fi-Fi System	4 x Fixed CO2 System
Fire Detection & Alarm	N 8000

LIFE-SAVING EQUIPMENT

Life Rafts	6 x 25, 2 x 10 men, SOLAS Compliant
Rescue Boat c/w Davit	1 x 6 men, 25 HP Outboard, 3 L/hrs, SOLAS Compliant

PRINCIPAL PARTICULARS

LENGTH O.A.36.00 M
 LENGTH B.P.33.20 M
 BREADTH MLD.7.60 M
 DEPTH MLD.3.65 M
 DESIGN DRAFT1.88 M
 COMPLEMENT8 CREWS
70 OFFSHORE WORKERS

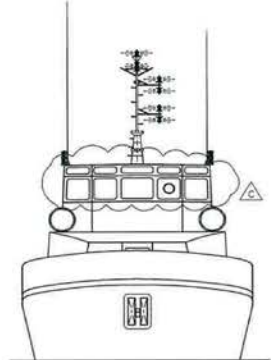
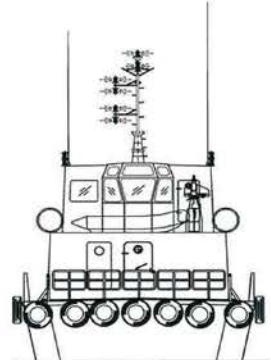
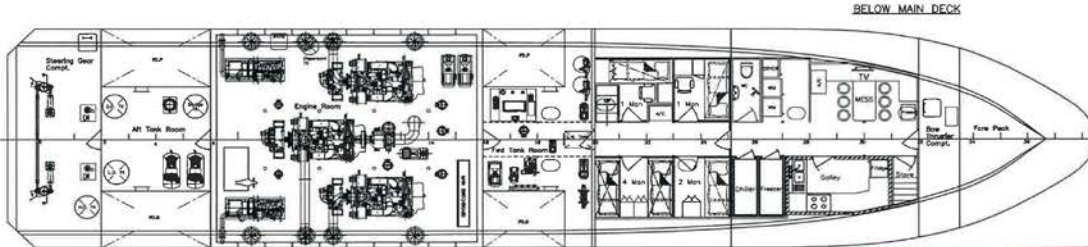
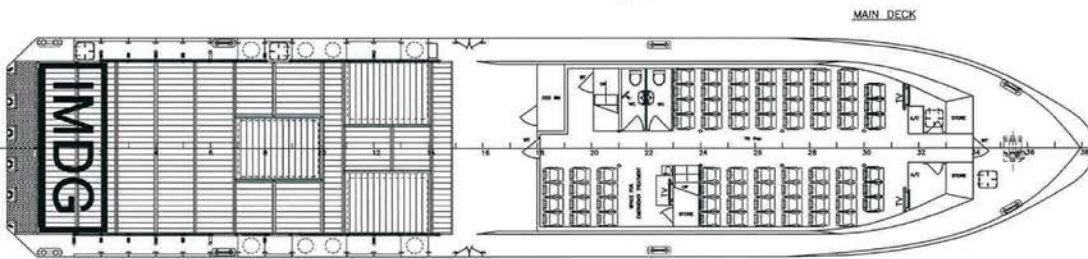
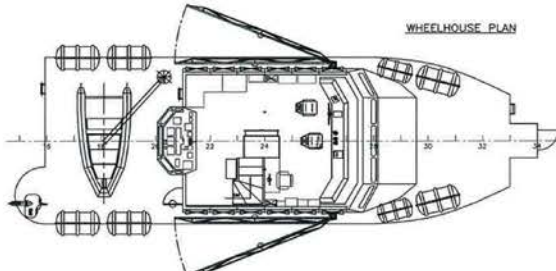
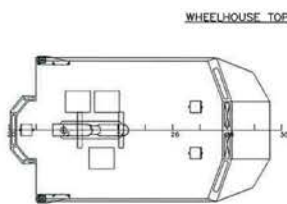
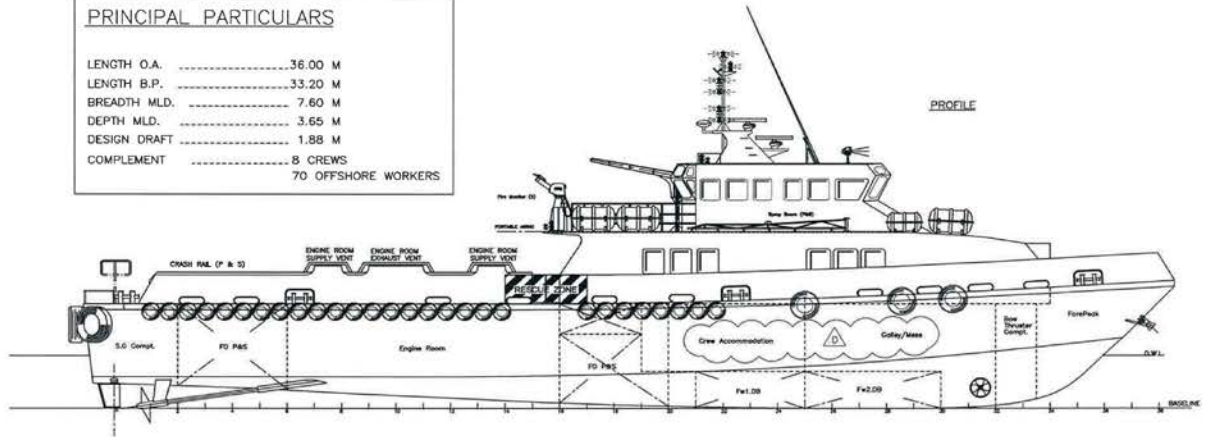

AS BUILT
 Date: 01 APR 2012

Rev	Modification	Date	Done	Remark
D	Revised compl. name in profile view	29,NOV,2011	ZH	Yard Comment
C	Update W/H windows	03,MAY,2011	ZH	Yard Comment
B	Rearrange Galley/Mess Room & Crew Accommodation	20,APR,2011	ZH	Owner Request

PROJECT: Flex-36 (H182)
 TITLE: GENERAL ARRANGEMENT

PENGUIN SHIPYARD INTERNATIONAL PTE LTD
 18 Tuas Street, Singapore 630784. Tel: 68283322. Fax: 68271150
 This drawing and the information contained herein is supplied on the understanding that they are the exclusive property of Penguin Shipyard International Pte Ltd. They must not be used or reproduced in whole or in part, without permission in writing.

DRAWN: ZH	DATE: 04,MAR,2010	SCALE: 1:75 (A1)
CHECKED: PATRICK	DATE: 04,MAR,2010	REVISION: 0
DRAWING No: PBIL-H188-G-01		SHEET: 1 OF 1