



EKSPRES 70

Fast Utility Craft/ Crewboat

PRINCIPAL PARTICULARS

Year Built	2012
Place Built	Singapore
Design	Penguin Shipyard Int'l
Flag	Malaysia
Length Overall	36.00 m
Length BP	32.40 m
Breadth Moulded	7.60 m
Depth Moulded	3.65 m
Draft (max)	1.82 m
Freeboard (SLL)	1.51 m
Class	BV
Notation	I, + Hull, + Mach, Crewboat, Urestricted navigation, Max Significant Wave ht 3.0 m
GRT/ NRT	239.00 T / 71.00 T
Deadweight	114.45 T

DECK PARTICULARS

Clear Deck Area	80.00 m ²
Deck Carrying Load	40.00 T
Deck Strength	2.00 T/m ²

PERFORMANCE

Maximum Speed	25 Knots @ 16 T/24 hrs @ 31 T DWT
Economic Speed	23 Knots @ 14 T/24 hrs @ 31 T DWT

PROPULSION SYSTEM

Main Engines	3 x Cummins KTA 38-M2, 1350BHP @ 1900 RPM
Auxiliary Engines	2 x Cummins 6BT5.9DM, 80 kW @ 1500 RPM
Portable Generator	DENKO KDE 3300, 115/240 AC, 3.6 kW
Bow Thruster	45 kW Electro Hydraulic
Propellers	3 x Fixed Pitch Propellers
Steering Gear System	2 x Electro Hydraulic RAM
Rudder	2 x Balanced Rudder

TANK CAPACITIES

Fuel Oil	60.00 m ³ @ 95% fill
Fresh Water	28.10 m ³ @ 95% fill

DECK EQUIPMENT

Anchor Windlass c/w Bow	HYPAC HHAW 15-32 415V, 4 kW
-------------------------	-----------------------------

ACCOMMODATION

Passenger Seats	70
Crew	2 x 1, 1 x 2, 1 x 4 = 8



EXTERNAL FIRE-FIGHTING EQUIPMENT

Fi-Fi Notation	Equivalent to 1/4 Fi-Fi c/w Water Spray System
Fi-Fi Monitors	600 m ³ /h, 115 m Throw Length
Fi-Fi Pump	600 m ³ /hr, SFP 250x350xP
Oil Dispersant System	Inductor, Proportion Pump, 200 L

INTERNAL FIRE-FIGHTING & ANTI-POLLUTION EQUIPMENT

Emergency Fire Pump	YANMAR, 30m ³ /hrs
CO2 Fi-Fi System	Fixed CO2 System for Engine Rm @ 35m head
Fire Detection & Alarm	Apollo M8000

LIFE-SAVING EQUIPMENT

Life Rafts	6 x 25, 2 x 10 men
Rescue Boat c/w Davit	1 x 6 men, 25 HP Outboard engine, NON-SOLAS

PRINCIPAL PARTICULARS

LENGTH O.A. 36.00 M
 LENGTH B.P. 33.20 M
 BREADTH MLD. 7.60 M
 DEPTH MLD. 3.65 M
 DESIGN DRAFT 1.88 M
 COMPLEMENT 8 CREWS
 70 OFFSHORE WORKERS

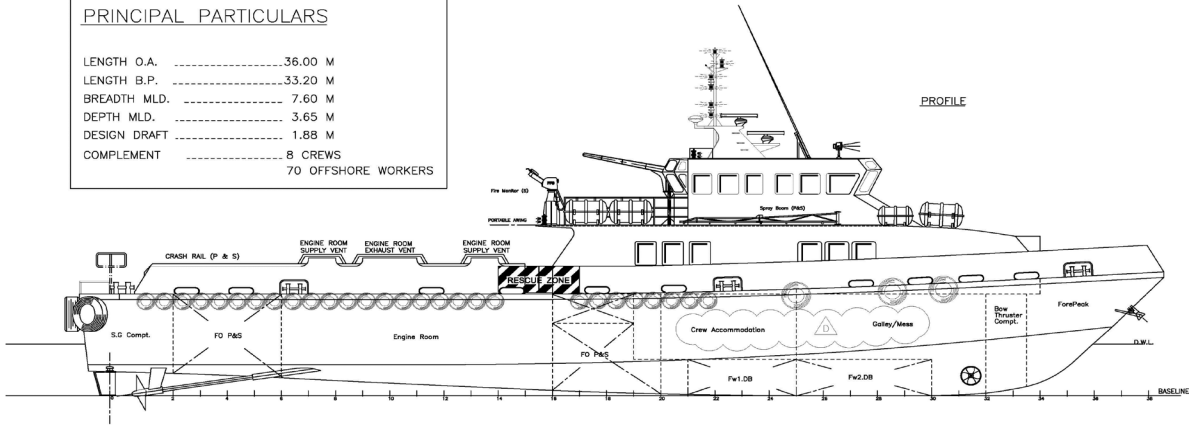

PROFILE

WHEELHOUSE TOP

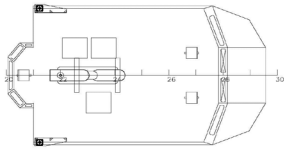

WHEELHOUSE PLAN

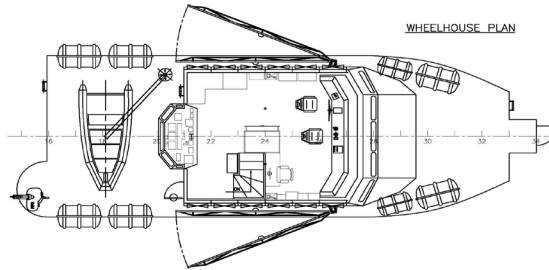

MAIN DECK

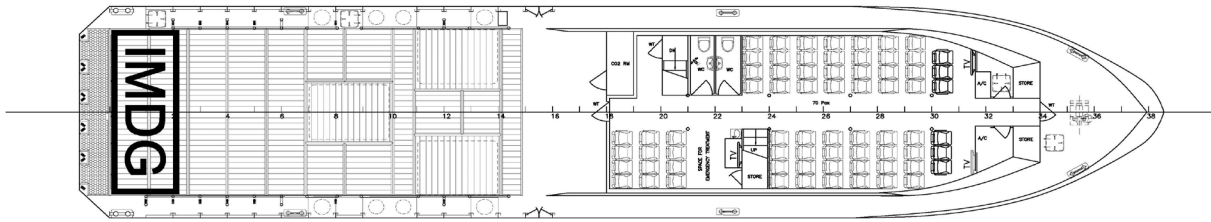

BELOW MAIN DECK

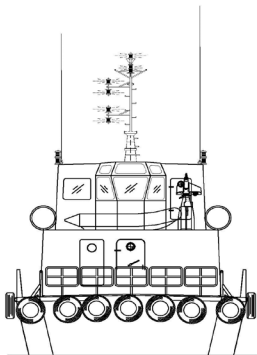
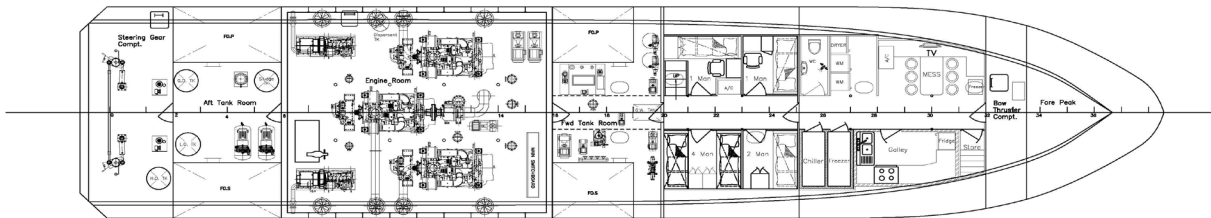

STERN VIEW

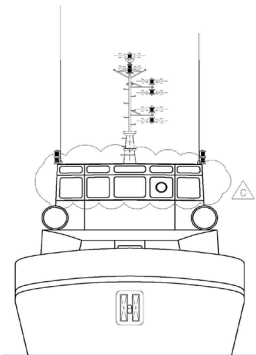

FRONT VIEW

D	Revised compt. name in profile view	29,NOV,2011	ZH	Yard Comment
C	Update W/H windows	03,MAY,2011	ZH	Yard Comment
B	Rearrange Galley/Mess Room & Crew Accommodation	20,APR,2011	ZH	Owner Request
Rev	Modification	Date	Done	Remark

PROJECT: Flex-36 (H180)

TITLE: GENERAL ARRANGEMENT

PENGUIN SHIPYARD INTERNATIONAL PTE LTD
 18 Tuas Basin Link, Singapore 638784 Tel: 68628322 Fax: 68622150

This drawing and the information contained herein is supplied on the understanding that they are the exclusive property of Penguin Shipyard International Pte Ltd. They must not be used or reproduced in whole or in part, without permission in writing.

DRAWN: ZH	DATE: 04,MAR,2010	SCALE: 1/75 (A1)
CHECKED: PATRICK	DATE: 04,MAR,2010	REVISION: D

DRAWING No.: PBL-H168-C-01 SHEET: 1 OF 1