



**MEO**  
MICLYN EXPRESS OFFSHORE

## EXPRESS 36

Crewboat/ Utility Vessel

### PRINCIPAL PARTICULARS

Year Built	1999
Place Built	Singapore
Design	Ship Tech, Singapore
Flag	Panama
Length Overall	34.00 m
Length BP	30.20 m
Breadth Moulded	7.60 m
Depth Moulded	3.30 m
Draft (max)	1.73 m
Freeboard (SLL)	1.28 m
Class	BV
Notation	HULL, MACH, Special Service/ Crewboat, Coastal Area
GRT/ NRT	210.00 T / 64.00 T
Deadweight	142.87 T

### DECK PARTICULARS

Clear Deck Area	85.00 m <sup>2</sup>
Deck Carrying Load	40.00 T
Deck Strength	1.00 T/m <sup>2</sup>

### PERFORMANCE

Maximum Speed	20 Knots @ 8.5 T/24 hrs
Economic Speed	17 Knots @ 5.5 T/24 hrs

### PROPULSION SYSTEM

Main Engines	2 x Caterpillar 3412 Ditta, 850 BPH @ 2100 RPM
Auxiliary Engines	2 x Detroit Diesel GM 4-71, 60 kW
Portable Generator	Denko KDE3300, 3 KW
Emergency Generator	Denko KDE3300E, 3.6 KW
Propellers	3 x Fixed Pitch Propellers
Steering Gear System	Duplex Electro Hydraulic System
Rudder	2 Units

### TANK CAPACITIES

Fuel Oil	54.34 m <sup>3</sup>
Fresh Water	21.24 m <sup>3</sup>

### CARGO DISCHARGE CAPACITIES

Fuel Oil Pump	10 m <sup>3</sup> /hr @ 15 m head
Fresh Water Pump	Marathon 5 KC39RN114GT, 3/4 HP
Bilge	30 m <sup>3</sup> /hr @ 30 m head

### DECK EQUIPMENT

Anchor Windlass c/w Bow	Windlass w/ Wire Rope and Drum
-------------------------	--------------------------------



### ACCOMMODATION

Passenger Seats	94
Crew	6

### EXTERNAL FIRE-FIGHTING EQUIPMENT

Fi-Fi Notation	Ext Fire-Fighting pump, 250 m <sup>3</sup> /hr @ 85 m head
Fi-Fi Monitors	2 x 150 m <sup>3</sup> /hr @ 10 bar
Fi-Fi Pump	250 m <sup>3</sup> /hr @ 85 m head
Oil Dispersant System	Nil

### INTERNAL FIRE-FIGHTING & ANTI-POLLUTION EQUIPMENT

Emergency Fire Pump	Portable Diesel Engine Driven Pump
CO2 Fi-Fi System	Fixed CO2 System for Engine Room, 3 Bottles
Fire Detection & Alarm	Smoke Alarm, Heat Alarm

### LIFE-SAVING EQUIPMENT

Life Rafts	8 x 25 men, SOLAS Compliant
------------	-----------------------------

Particulars are believed to be correct but not guaranteed. Owners reserve the rights to amend the specifications without notifications. Particulars are entirely without warranty as to correctness and interested parties must inspect vessel's certificates, drawings or physical inspection of vessel.

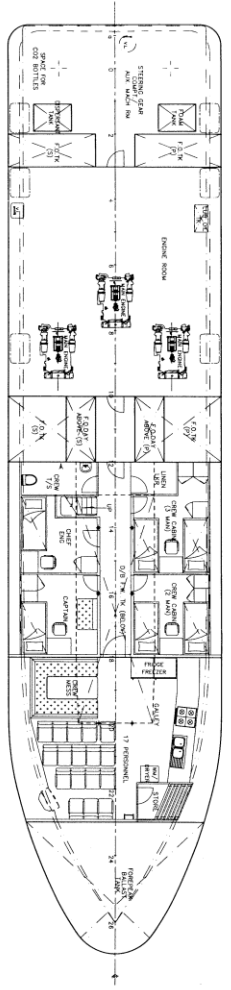
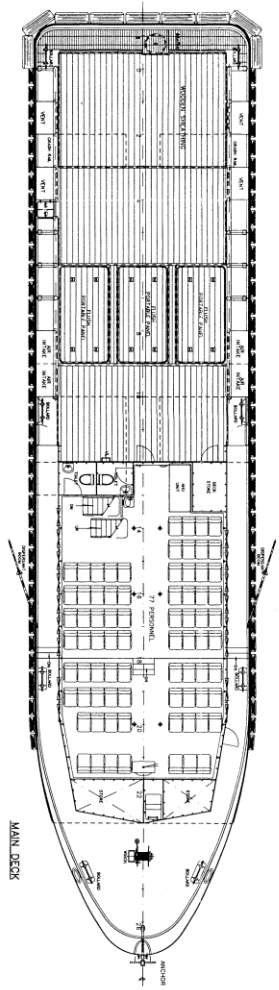
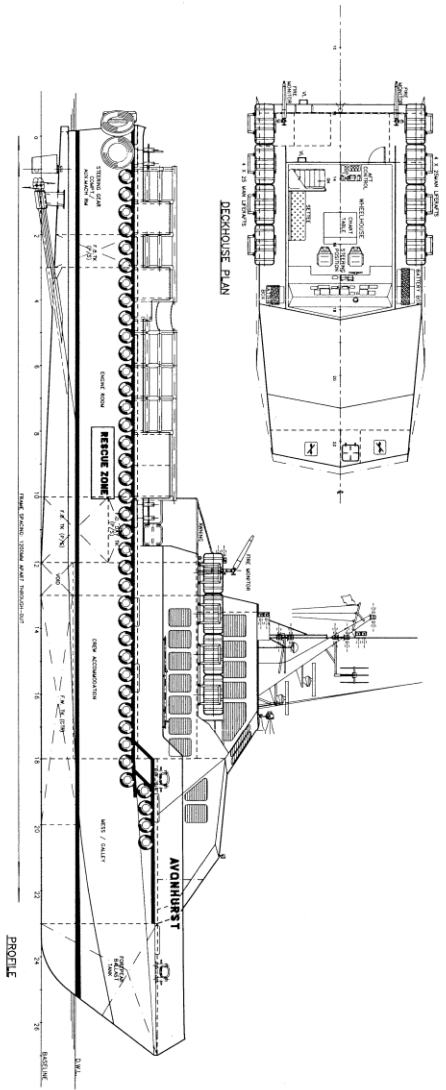

**PRINCIPAL PARTICULARS**

LENGTH O.A. .... 34.00 M  
 LENGTH W.L. .... 31.60 M  
 LENGTH B.P. .... 30.20 M  
 BREADTH MLD. .... 7.60 M  
 DEPTH MLD. .... 3.30 M  
 DESIGN DRAFT MLD. .... 1.20 M  
 COMPLEMENT ..... 7 CREW

94 PERSONNEL



Approved: *[Signature]* 25 MAY 1999

APPROVED BY: \_\_\_\_\_  
 ON: \_\_\_\_\_  
 The drawing and the information contained herein are the property of the undersigned and shall not be used or reproduced in whole or in part without the written consent of the undersigned.

NO.	AS BUILT	NO.	DATE
<p align="center"><b>SHIPTECH</b>          NAVAL ARCHITECTS          180 Royal Palm Way, Suite 200          Ft. Lauderdale, Florida 33305          F-MAIL: shipstech@earthlink.net</p>			
PROJECT	M.V. "NONHURST" 34M CREW / UTILITY VESSEL		
TITLE	GENERAL ARRANGEMENT		
DESIGNER	SCALE	SHEET NO.	SHEET OF
WALKER	1:75	ST1166-01	F
DATE	1-75	DATE	01

